

St Laurence Church Rowington



Graveyard Index

18 February 2025

Contents

Important Notes	3
Introduction to original volume	4
Graveyard Map	5
Map of Recent Graves (post-1920) and Cremation Burials	7
Interior Map.....	9
Index of Interior Memorials and Tombs	9
Surname Index	11
Cross reference of Grave numbers and Names/Inscriptions	16
Orphaned Inscriptions	40
Index of Surnames from the Burial Registers	41
Historical Notes on families	49

Important Notes

This graveyard index is based on the graveyard book that is kept in the Lady Chapel of St Laurence Church, Rowington and is reproduced with the kind permission of the Rector and Churchwardens.

The original book contains the churchyard map of the graveyard as it stood in 1980, plus a map of the memorials inside the church along with the surname index and to this has now been added the layout of the more recent graves from 1900 onwards. The drawings of the pre-1900 tombs and the transcriptions of the inscriptions, which together form the bulk of the graveyard book, have been scanned as images which are available on the Rowington Records website at

RowingtonRecords.com/Church/St Laurence Rowington/Churchyard map/index.html

These have now been transcribed and are included for the first time in this version of the index. Higher resolution images of the graveyard maps and scans of the burial registers from 1859 onwards are also available online.

This document probably best viewed online to take advantage of the zoom and search facilities of Acrobat Reader.

The index has now been updated to include the graves from the point in about 1920 when burials were made in ordered rows rather than following the previous practice of a rather more random arrangement. Some burials continued to be made in the old section of the graveyard after 1920 and the documentation for these is unfortunately missing. Where there is still a visible gravestone they have been included, but some will inevitably have been missed.

A surname index for entries in the burial registers from 1859 is also included, this includes entries for graves which are unmarked or no longer visible.

Graves in the old part of the graveyard are identified by a purely numerical reference (e.g. 180), the more recent graves are identified by the row and number (e.g. H23). Interior memorials are prefixed with "Mem" and inscriptions on the war memorial with "WM". Burials of ashes are identified with the prefix "CREM". Early burials of ashes are in a small plot at the North end of Row D. More recently they have been buried along the East wall of the church and a separate map of these is included.

I am grateful to the relatives of Elizabeth and John Pinfold; whose evident joy at locating the grave of their great, great grandparents by reference to the graveyard book inspired me to make it available online to anyone else with ancestors buried in Rowington Churchyard.

Nick Holmes

February 2025

Introduction to original volume

The aim of this survey was to record the graves and memorial tablets in the Church of St Laurence, Rowington, up to the year 1900.

The survey was conducted by members of Rowington Women's Institute at the request of the Birmingham and Midland Society of Genealogy and Heraldry. Similar projects were concurrently conducted by 90 other Women's Institutes throughout Warwickshire, and 114 Churches were surveyed.

The field work at St Laurence and the subsequent compilation of this record was carried, out during the period July 1980 -April 1981. The participants have endeavoured to depict accurately the position and inscriptions of all the monuments they could find. Inevitably, the encroachments of nature and the ravages of time have concealed many graves or rendered parts of inscriptions illegible, and thus, the survey cannot be comprehensive.

This record gives details of graves and 24 monuments within Church. Their positions can be identified by reference to the maps accompanying each section.

April 1981

OLD VICARAGE

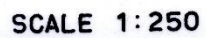

ST LAURENCE
ROWINGTON

ROAD

Map of Recent Graves (post-1920) and Cremation Burials

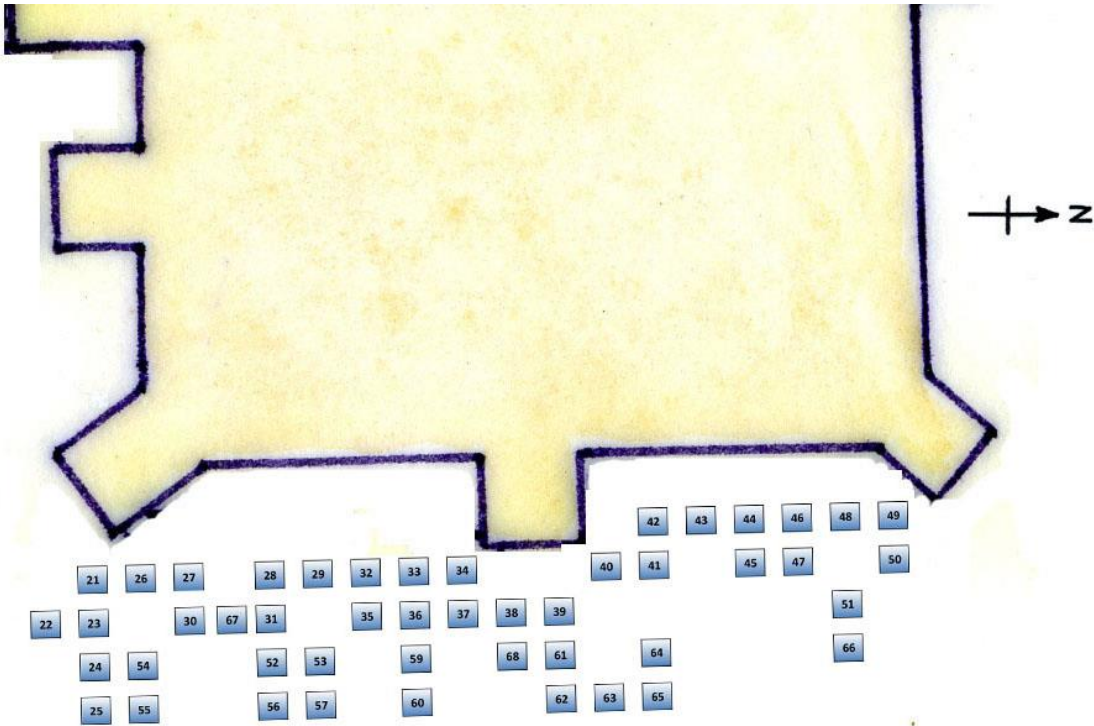
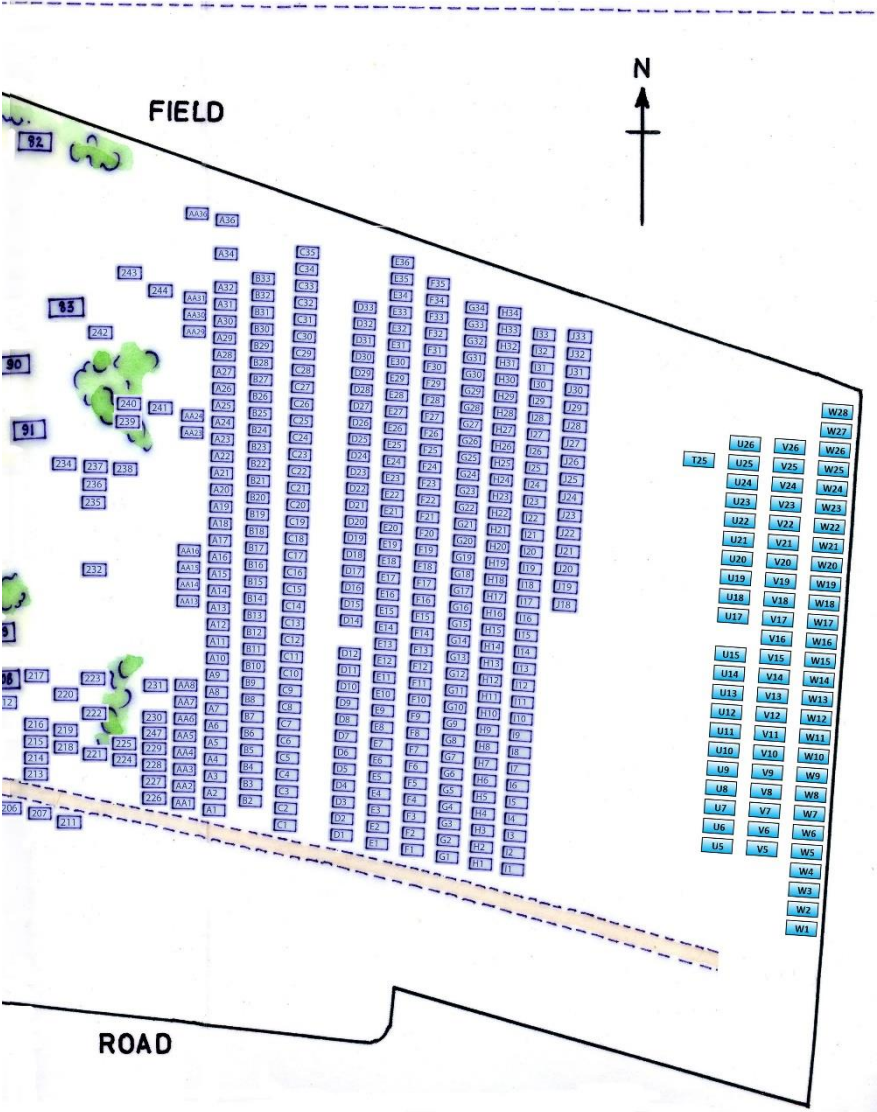

Interior Map

Index of Interior Memorials and Tombs

Aston	M	10
Aston	S	10
Aston	S	12
Bradbury	J	2
Brodie	IO	24
Brodie	PB	8/9
Hill	J	1
Oldnall	J	16
Reeve	E	17
Reeve	F	23
Reeve	R	4
Reeve	R	5
Reeve	T	14
Smallbroke	E	21
Smallbroke	S	20
Southern	B	15
Southern	W	15
Stonhall	J	6
Thompson	M	11
Wall	A	22
Wall	J	22
Wallace	T	3
Weale	E	18
Weale	G	19
Wollaston	WJ	13

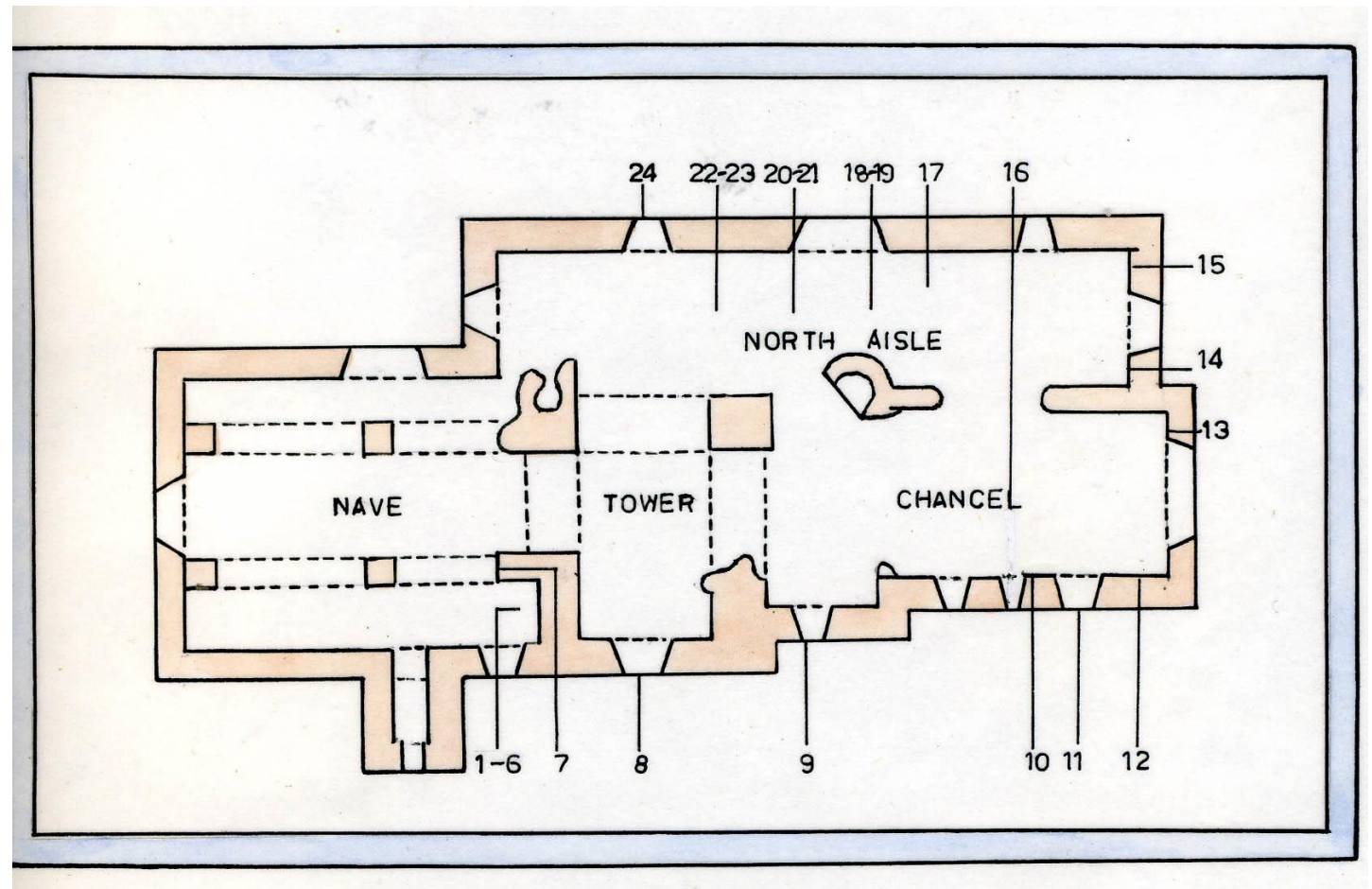

Surname Index

A

Adams	A10, AA7, E13, V22
Adie	J32
Alderson	J30
Allday	A2, A4
Allen	B13, C5
Andrew	F19
Annetts	I4
Appleby	CREM60
Arthur	232, E34
Ashwood	102
Aston	131, 162, Mem10, Mem12
Attwood	W22
Austin	C1, C2, WM24
Avern	61, 84, 85, 86, 87, 88, 89, 90, 128, 130, 152, A14, B21

B

Bachelor	D17, D22
Badger	A6, B6
Bailey	D2, W12
Bainbridge	CREM43
Baker	1
Baldwin	G8
Ball	144
Barlow	B19, F26, I31
Barnett	182, 183, 185, 219
Barton	G9
Bassett	F20
Beachamp	I27
Beardsmore	F13
Beasley	G21, G6
Beck	CREM45
Beckett	W8
Beecham	237, 238, E15
Berridge	I6
Betts	164, 165, C19
Bevins	U23
Birtles	D12, WM25
Bladon	B30
Blizzard	V12
Blyth	I15
Boggust	CREM31
Bolton	21, 22, 23, 24, 25, 26, 28, 41, 44
Booth	C35, CREM11
Boucker	G15
Bowcott	V6
Boyles	AA23
Br---	126

Bradbury	186, 187, Mem2
Bradley	F32
Bragg	C33
Brain	CREM33
Branson	229, AA2, B2
Brittain	C25
Brodie	6, Mem24, Mem8, Mem9
Brown	252, J18, W20
Brownhill	U25
Bubb	D21
Bunn	AA29, C29, D31
Burge	148
Busby	206
Buttwell	G10

C

Caldwell	J33
Calvert	H21
Cambray	W24
Canto	CREM54
Cashmore	E21
Cauldwell	V20
Chambers	E8
Chapman	196, I33, W2
Chatterley	F33
Cheshire	CREM28, CREM4
Christophers	201, U8
Clarke	CREM67, D6, W18
Clarke-Williams	CREM46
Clews	A11
Clinton	D24
Clutterbuck	G33
Cockes	112
Cocks	CREM44, CREM5
Cole	CREM49
Coleman	CREM47, H19
Collins	CREM42
Cookes	177
Coop	CREM34
Cooper	223, B28
Corbett	5, 193, 251
Cornah	I20
Courtnall	H4
Cousins	A7
Cox	CREM63
Crapper	142, 143
Currall	202

D

Dance	U15
Davies	190, I12, V26, W19
Dean	B9
Dee	V24

Digwood	I23	Gibbs	110
Dilley	CREM35	Gilbert	107, E28, H6
Dipple	I17, WM16	Gill	D28, H3
Docker	I10	Glaze	228
Dodd	V15	Gold	10, A17, A19, AA16
Doggett	E33	Goode	I16
Donnelly	B16	Goody	F7
Dormer	H34	Gould	171, U6
Draper	5, AA15, C24	Graham	W5
Dumbleton?	B29	Green	AA29, J31, V14
Durrant	WM26	Gregory	G26
Dyson	CREM14	Greves	113, 114, F3
E		Grice	AA31
Eastman	F8	Grove	11, 13
Easton	CREM38	Gumbley	34
Eborall	124	Gurden	C8
Edgecox	246	H	
Edmund?	CREM12	Hadley	I24
Edwards	200, CREM22, CREM55, F27, WM11	Hale	CREM51
Eggleton	B33, C34	Hall	G20
Etheridge	H27	Hancock	202, A23
Eton	173	Hancox	111
Evans	71, CREM39	Handley	29, 92
Everitt	194	Hanson	108, 245, E22
F		Harbon	C15
Fairfax	234	Hardiman	E26, G23
Fardon	C3, C4	Harding	42
Featherston	74, 115, 116, 117	Harper	H31
Featherstone	118	Harris	B24, C21
Fell	CREM41	Harrison	CREM2, CREM3
Fisher	CREM66	Hatton	CREM13
Fitzpatrick	V8	Hawker	H12
Floriday	A16	Hawkes	59, 166, F18
Flower	F28	Haycock	I13
Folley	CREM36	Hayden	J28
Forty	G16	Haydon	D18
Fox	W27	Heath	A27
Francis	D3	Hemming	AA1
Freeman	H16, W26	Heritage	G18, V13
French	167	Hewitt	C16, D19, F16, I5
Fulford	124	Hibberd	160
Fullard	148	Hibbs	U19
G		Hill	CREM40, E24, Mem1
Gallimore	A21	Hirons	F14, H11
Gardener	33, 146	Hitches	V17, V7, W7
Gardner	I21	Hobday	U17
Gazy	50	Holding	J25
Gazy?	51	Hollick	D1
Gem	39, 40	Holmes	W11
Ghent	236, WM23	Hopcraft	212, B31, H9, WM3
		Hopes	G27

Hopkins	60	Manton	I26
Hopson	A36	Martin	31
Houghton	B22	Masters	167
Hurley	F30	McCloskey	V18
Hutchinson	B20	McLennan	A22
Hyde	E36	McWilliams	210
I			
Ingram	AA6, C6, E27	Meacock	189
Insley	B3, F17, I9, V9	Meakin	F29
Ives	A5	Meanley	C23, D4
J			
Jackson	44, D25, I32, U14	Meigh	231, D26
Jarrett	G32	Meredith	162, 195
Jarvis	CREM24	Merriman	AA1, WM20
Jenkins	148, 159, E11, F21	Merry	37, 38
Johnson	199, 211, CREM48, CREM61, CREM62, G1, G22, U12, WM14	Middle---	172
		Middleton	103, 104
		Millington	E19
		Mitchell	A15
		Moore	140, 141, 222, 240, D14, WM22
Jones	F2		
K			
Kean	G25	Morley	209, B15
Kelland	CREM25	Morris	G2, G5, U20
Keller	AA14	Morton-King	W17
Kember	230	Moseley	81, 174, 248, F6
Kendrick	179, 180	Mould	CREM29
Kettle	241	Moulden	I22
King	7, 147, U7	Mumford	242, A13, C11, H24
Kirby	B23	N	
L			
Lakin-Smith	208	Nash	148
Lancaster	J29	Neal	V11
Landeryou	D20	Neale	C30, D29, E20, I18, J27, WM17
Lane	239, A30, H25, H26		
Lawrie	J20	Newbery	45, 46, 47
Lea	175, 176	Newton	B4
Lee	V19	Nichols	AA4
Leigh	CREM17	Norton	148
Lickorish	CREM64	O	
Linforth	A18	Oakley	W23
Lingard	197	Oldnall	Mem16
Linzey	244, F4, G4, I14	Oliver	221, AA3
Lowe	E7, F11, U18	-olt	122
Lynton	30	Orcutt	204, WM19
M			
Madeley	195	Orton	H27
Malin	WM15, WM8	Osborn	159
Malins	C17, WM9	Ostins	CREM16
Mander	225, E3	AP	
Manders	62, 63, 64	Paddock	F23
Mann	247	Page	B7, W25
		Palmer	83, 93, 94, 95, 96, C27, CREM1, G28
		Parker	CREM23, CREM6
		Parkes	F15

Payne	C18	Sayce	G3, W3
Peebles	CREM59	Schofield	J24
Pendleton	D5	Scholefield	161
Penrice	V16	Scotland	I2
Pershhouse	44	Seddon	CREM52
Pettit	133, 137, 138	Sharman	145
Petty	CREM26	Shaw	CREM15
Phillips	H15, U21	Sheenan	CREM37
Pickering	C12, I3, W29	Shellard	E10, F10
Pickett	142	Sheppard	2
Pinfold	49	Sheridan	U13
Pittaway	H7	Simmons	W1
Pitts	V5	Simpson	D16, E34
Plant	169, 170	Skerrett	I1
Plowman	E12, G7	Skinner	D10
Powell	A24, W13	Sly	9, 214, 215, 243, C7, E1, I11, W15, WM13
Powles	E4	Smallbroke	Mem20, Mem21
Price	F24	Smith	15, 16, 72, 188, 196, 198, 226, A25, B25, CREM30, CREM56, E29, F1, F5, H13, H22, H33, W4, W9, WM5, WM7
Priest	213, 216, 218, AA8, B10, B11, C10, D30, E17, E18, H30, J22, U10, U9, WM21	Snook	E31
Pritchard-Gordon	250	Soden	B32
Prue	A20	Southern	Mem15
Puddifoot	E35	Spencer	224
Pullen	T25	Srawley	F22
R		Stead	180, 184
Rabin	150, D27, I19	Stephens	203
Radbourn	G29	Stonhall	Mem6
Ray	227	Styles	U24
Read	249	Swain	CREM50
Redfearn	CREM10	Sweetman	B14, C32, E5
Reeve	97, AA13, E6, Mem14, Mem17, Mem23, Mem4, Mem5, U26	AT	
Regan	J19	Tabor	J23
Reynolds	111, 205	Tarplee	I29
Richardson	D11	Taylor	8, 67, 68, 69, 70, 80, 99, AA36, C31, E25, G19, V10, V23, W14, W21
Rickett	V25	Teale	C9, D15, WM18
Roberts	CREM68	Theobold	E32
Robinson	3	Thompson	168, Mem11
Roden?	G34	Tibbetts	32
Roe	78, 79	Tibbitts	154, 155, 156, 157, 158
Rogers	AA30	Tillyer	G12
Ross	D32, E16	Todd	220, E23
Rowe	CREM32	Tovey	C13, D7
Rowney	A29, H32, WM10	Turnbull	I7
Rudge	A3, W28	Turner	CREM21, F9, G17, G30, H14
Ryland	191, 192	Turton	153, AA24, H10, H17
S			
Satchwell	I8		
Savage	D33, H18		

U

Unknown	4, 12, 14, 17, 18, 19, 20, 27, 48, 65, 66, 91, 98, 100, 101, 105, 106, 109, 119, 121, 123, 125, 127, 129, 132, 134, 135, 136, 139, 149, 151, 163, 178, 181, A34, CREM8
---------	--

V

Vardy	WM1
Veale	B17
Vegnuti	U11
Viggers	D8, E9, H20

W

Waistell	H8
Wakefield	G11
Waknell	B8
Walden	C28
Walker	A1, F35, I30
Wall	E30, Mem22
Wallace	Mem3
Wallington	F12
Wallis	167, A26, B27, G13, G24
Ward	C20
Wareing	H5
Warmington	73
Warner	H23
Watson	CREM53
Weal	168
Weale	Mem18, Mem19
Webb	C26, G31
Weetman	A31, A8, F34
Weetman?	AA5
Weir	U5, W10
Wells	52, 53, 54, 55, 56, 57, 58
Westwood	217, B5, F31, W6
Wheeler	43, 44
White	36, 75, AA23, D9, H1, H2, H29
Whitehead	C14, G14, I25, U22
Whitehouse	J26
Whitfield	A12, E36
Whyman	B26
Wiggett	D23, F25

Wiggins	B12
Wilcox	CREM57
Wild	V21
Wilkes	CREM58
Wilkins	B18
Williams	35, CREM9, I28, J21, WM4, WM6
Willmore	76, 77
Willson	E14
Wilmin	120
Wilson	207
Wimlett	CREM7, H28, W16
Wollaston	Mem13
Wood	235
Woodall	CREM27, CREM65
Woodward	82, A32, C22
Woolloff	E2, WM12
Worwood	A28
Wright	A9, WM2

Notes:

Graves with a simple number (e.g. 137) are located in the old part of the graveyard

Grave numbers like J12 are located in the new part of the graveyard (J12 is plot 12 in row J)

Graves prefixed with "CREM" are cremation burials located at the North end of row D or along the East wall of the church

The prefix "WM" indicates the War Memorial and "Mem" indicates a memorial inside the church.

Cross reference of Grave numbers and Names/Inscriptions

Notes:

Images of the inscriptions of graves 1-189 (including some drawings of the graves themselves taken from the WI survey in 1980) are on the Rowington Records website: RowingtonRecords.com/Church/St Laurence Rowington/Churchyard map/index.html

Numbers in square brackets indicate entry numbers from the burial registers

- 1 In loving memory of JAMES HENRY BAKER Born November 2nd 1843 Died November 1st 1898. Thou shalt rest in Peace. Also of HANNAH wife of the above Born November 15th 1839 Died November 19th 1903
- 2 In loving memory of ALICE ELLEN SHEPPARD Born September 11th 1855 Died September 23rd 1889. Blessed are the pure in heart for they shall see God
- 3 In loving memory of RICHARD ROBINSON of Finwood Lawn Born Jan'y 10th 1803 Died June 27th 1881 The just shall live by his faith. Habakkuk 2 ch. 4 ver.
- 4 T.D.
- 5 In loving memory of ELIZABETH wife of William Draper who died Sep'r 29th 1894 Aged 76. Also WILLIAM DRAPER who died Nov'r 7 1905 Aged 87. Also of THOMAS DRAPER who died May 1st 1896 aged 74. Also of NELLIE DOROTHY youngest daughter of THOMAS and MARY CORBETT passed away Oct'r 30 1918 Aged 19
- 6 To the Beloved Memory of HENRY FRANCIS SEDGWICK BRODIE who died in Canada West November 26th 1868 Aged 25 years and the Rev. ARTHUR WILLIAM LAWSON BRODIE B.A. who died June 13th 1874 Aged 23 years. THEODORE STUART BRODIE Lieu. Commander R.N. Killed in the Dardanelles April 17th 1915. PHILIP WYNDHAM BRODIE Cap: Seaforth Highlander. Died at Taranto Italy, on active service Nov 18th 1918. The dear sons of GG & LM Brodie Thanks be to God which giveth us the Victory through our lord Jesus Christ 1 Cor. 15.C. 57V To the Beloved Memory of PETER BELLINGER BRODIE, M.A.F.G.S. 44 years Vicar of this Parish sometime Rural Dean Born January 27th 1815 Died All Saints Day 1897 The works of the Lord are great, sought out of all them that have pleasure therein. Psalm CX1. V2. To the Beloved Memory OF ISABELLA OCTAVIA BRODIE Wife of Rev. P B Brodie Vicar of Rowington Born Feb 7th 1821 Died Nov. 17th 1896 Her children rise up and call her blessed Prov 31.0. V.28 To the Beloved Memory of DOUGLAS MORRISON WOOD BRODIE B.A. November. 18th 1894 Aged 38 years Blessed art the pure in heart for they shall see God. S. Matthew 5.0.8.V.
- 7 In Loving Memory of WILLIAM KING of Shrewley who died April 7th 1906 Aged 66 years Also of ELIZABETH Daughter of William & Elizabeth King who died Feb 26th 1881 Aged 5 months He shall gather the lambs with his arms For here have we no continuing City, but we see one to come In Loving Memory of ELIZABETH Widow of William King Who died May 29th 1912 Aged 71. years
- 8 Sacred To the memory of JOHN TAYLOR Late of the Parish Who died July 8th 1845 Aged 72 years Also LUCY his Wife Who died Feb 21st 1855 Aged 84 years
- 9 In Loving Memory of WILLIAM MANTON SLY, Who died Dec 13th 1889, Aged 79 years Also of DINAH SLY Who died April 4th 1878 Aged 64 years. "Surely he hath borne our griefs and carried our sorrows." Also of EMMA SLY Who died Jan-y 26th 1865 Aged 22 years Also of SARAH MARIA SLY Who died April 8th 1869 Aged 17 years Also of CHARLOTTE SLY Who died June 26th 1886 Aged 36 years Also of FREDERICK SLY Who died Feb 17th 1857 Aged 2 years
- 10 Mizphh' In Loving Memory of ELLEN, Wife of John Gold, who died Aug:3:1908, Aged 62 and of JOHN GOLD who died June.2.1925, Aged 77 'He went about doing good' Also of ALICE Daughter of John and Ellen Gold, who died Nov: 22:1877 Aged 5 years Gone before Also of EDWARD, EMMA and HENRY Children of Henry and Anne Gold, who died in infancy "In Heaven their Angels do always behold the Face of my Father" In Loving Memory of HENRY GOLD Who died Feb 7 1894 Aged 83 Also of ANNE his wife Who died Dec 17. 1895 Age 84 "They rest from their labours"
- 11 Sacred To the Memory of THOMAS GROVE Who died February 12: 1843 Aged 55 years Also MARY relict of the above who died May 23: 1865 Aged 73 years Also GEORGE Son of the above who died May 10: 1841 Aged 23 years O Lord Thy will be done.
- 12 GGG (Possible footstone to No.11)
- 13 In Loving Memory of ELEANOR GROVE Died April 13th 1883, Aged 58 years Also of EMMA GROVE Died Dec. 15th 1894, Aged 61 years Rest in Peace

- 14 No inscription visible
- 15 To The Memory of CATTERN SMITH Spinster Who died Dec 9th 1820 Aged 65 years
- 16 To (---) Memory of THOMAS SMITH who died 21st Feb ... MARY His Wife
- 17 No inscription visible
- 18 In MARY
- 19 Only R ... 25th and ... 9 ... visible
- 20 No inscription visible
- 21 To The Memory of ISAAC BOLTON Died July 2nd 1809 Aged 70 years SARAH Wife of the above Died June 19 1821 Aged 86 years
- 22 Sacred to the Memory of WILLIAM Son of Isaac & Sarah BOLTON Late of the Parish of Claverdon in this County Died August 28th 1830 Aged 52 years
- 23 To the Memory of THOMAS BOLTON of this Parish Who died Aug 21 183(-)
- 24 To the memory of ANN, Wife of THOMAS BOLTON Who died Aug 24 1833 Aged 75 years
- 25 Sacred to the Memory of WILLIAM BOLTON who departed this life August 13th 1827 Aged 6 (-) years. Also (MARY) relict of William Bolton Who died July 4th 18(31) Aged 6(5) years
- 26 Sacred To the Memory of JOSEPH BOLTON Who died March (1) 1810 Aged (8) 6 Also MARTHA his Wife who died Nov 7 1810
- 27 No inscription visible
- 28 Sacred To the Memory of SARAH Relict of ISAAC BOLTON who died 8th of September 1850 Aged 74 years
- 29 In Memory of ANN Wife of Joseph Handley who died August 15 1881 Aged 68 years Also of JOSEPH HANDLEY who died March 6 1883 Aged 64 years And now Lord what is my hope Truly my hope is then in thee
- 30 In Memory of HANNAH (LY)NTON who departed this life (3rd or 5th) (Dec) 18(53 or 35) in the (90th) year of her life
- 31 In Memory of RICHARD MARTIN Who died Nov 7 1833 Aged 71 Also of MARY MARTIN Wife of the above & Daughter of Joseph Bolton Died Sept 13th 1797 Aged 27 Meek was her temper religious was her life a Prudent Mother & a Virtuous Wife Also of ANN Daughter of the above Died March 18th 1798 Aged 6 months and of CATHERINE their Daughter
- 32 Sacred to the Memory of RICHARD TIBBETTS (Late of Leamington in this County) Who departed this life 17th day of Nov. 1850 Aged 70 years Sacred to the Memory of ELEANOR TIBBETTS (Late of Leamington in this County) Who departed this life 30th May 1867 Aged 76 years
- 33 Sacred to the Memory of ELIZABETH GARDENER Who died March 21: 1857 Aged 25 -----) Beloved of all But (---- Rel --) Her (--- -----) her God
- 34 in Loving Remembrance of MATTHEW GUMBLEY Who departed this life February 22nd 1879 Aged 71 years Also of ABIGAIL Beloved wife of the above Who departed this life February 13th 1881 Aged 70 years
- 35 Sacred To the Memory of HANNAH the Beloved Wife of WILLIAM WILLIAMS of Rowington Warwickshire who departed this life October 15th 1870 Aged 59 years Blessed are the dead which die in the Lord from henceforth: Yea, saith the Spirit that may rest from their labours Rev. X1V.XIII
- 36 Affectionate Remembrance of JOB The beloved husband of ABIGAIL WHITE Who died Dec 17 1899, Aged 74 years His end was peace Thy will O Lord not mine Also of ABIGAIL The dearly beloved wife of the above Who died June 2 1914 Aged 81 years Sleep on dear Mother and take they rest We loved thee well but Jesus loved thee best
- 37 Affectionate Remembrance of EDMUND MERRY of Rowington Who died May 20th 1880 Aged 49 years Thy will be done O Lord
- 38 In Loving Memory of SARAH MERRY who died December 12th 1895 Aged 70 years Also of WILLIAM MERRY Husband of the above who died July 7th 1884 Aged 63 years In the midst of life we are in death S.M. W.M.
- 39 This Stone is Raised to mark the spot in which rests the body of RICHARD GEM Esq Formerly of the 7th Dragoon Guards and 72nd Reg. of Infantry Lastly of the Warwick Militia Who died on the 21st of Aug: 1848 Aged 7(1) Quieseat R.G. 1848
- 40 In Loving Memory of SAMUEL EDWARD GEM of Moor Hills Rowington, Who died 7th June 1871 Aged 74 years In Loving Memory of MARY ANNE GEM of Moor Hills Rowington Who died 4th Nov. 1915

- Aged 90 years In Loving Memory of MARY ANNE Wife of Samuel Edward Gem of Moor Hills Rowington Who died 27th July 1835 Aged 36 years In Loving Memory OF SAMUEL EDWARD GEM of Moor Hills Rowington Son of Samuel Edward Gem and Mary Anne his Wife Who died 3rd February 1890 Aged 61 years
- 41 RICHARD BOLTON who Died (----) April 17(0)9 Aged 60 Also RICHARD their Son Died (3 or 8?) March 1800 Aged 61 ELIZABETH His Wife Died 10th July 1792 Aged 91 Also MARY their Daughter Died 20 April 1766 Aged 33
- 42 In Memory of CHARLES HARDING Died Nov. 17th 1870 Aged 45 years Also HANNAH MARIA Widow of the above Died Dec. 31st 1904 Aged 72 years
- 43 Sacred to the Memory of WIL(-) AM WHEELER Who departed This Life Jan 18(-)3 Aged 77 years A Husband kind A Friend Sincere A Loving Father Lies buried here SARAH His Wife Who departed This Life July 18th 1823 Aged 63 years Afflictions Sorelong (----) bore Physicians were in vain Till God did please to give me ease and free me from my pain W.W. S.W.
- 44 Sacred to the Memory of SAMUEL JACKSON Who departed this life July 31st 1837 In the 71st year of his age. Sacred To the Memory of SARAH, Wife of EDWARD PERSHOUSE of Lillington Who died Jan 30 1866 Aged 75 years Them that are meek shall He guide in Judgment and such as are Gentle them shall He learn His way. Sacred To the Memory of WILLIAM BOLTON Late of Finwood Who died at Kenilworth Dec 11th 1873 Aged 75 Also of ELIZABETH Wife of the above Who died at Kenilworth Dec 29th 1875 Aged 78 So He bringeth them unto the Haven where they would be. Sacred to the Memory OF JOSEPH WHEELER (Late of Honiley) Who died 25th Dec. 1855 Aged 70 years Blessed is the man whom thou teachest Him and of Thy Law. Also of HANNAH BOLTON Who died at Stratford on Avon 28: May 1876 Aged 37 years
- 45 Sacred to the Memory of JOSEPH NEWBERY Who departed this life 16 day of Nov: 1853 in the Eighty first year of his age Also of ELIZA widow of the late Joseph Newbery of Rowington, who departed this life March 17th 1895 In the 90th year of her age "At Rest" Sacred To the Memory of JOSEPH NEWBERY (Late of this Parish). Who died April 18th 18(-)7 in the 56th year of his age Sacred to the Memory of ELIZABETH, Wife of Joseph Newbery Who departed this life 22nd Day of March 18(-)1 in the sixty fifth year of her age. In Loving Memory of MARY youngest Daughter of the late Joseph and Eliza Newbery at Rowington who entered into rest May 23rd 1896 Aged 51 years, To so he giveth his beloved sleep.
- 46 Sacred To the Memory of JOHN NEWBERY Late of Claverdon Who departed this life Nov 1st 1816 Aged 75 years
- 47 In Memory of JOHN NE(W) (BE)RY who died (--) June Aged (---) years
- 48 No inscription visible
- 49 In affectionate Remembrance of ELIZABETH The Beloved Wife of JOHN PINFOLD Who died May 15th 1875 Aged 79 years Also of the above JOHN PINFOLD Who died Aug.23 1876 Aged 87 years And as it is appointed unto men once to die. But after this the Judgment. Neb IX.XXVII
- 50 Sacred To the memory of WILLIAM GAZY Who died August 13th 1846 Aged 73 years (He was clerk of this Parish 45 years) Also MARY ANN his Wife who died April 14th 1843 Aged 62 years.
- 51 Memory ANN Daug (hter ---) Will'm. & M(-----) G(-----) Died (-----)
- 52 In Memory (----) (-----) WELLS Daughter of William and Elizabeth Wells who died (1)0 October (1802) Aged one year and three quarters
- 53 In Memory of RICHARD WELLS Son of William Eli Wells Who died Nov (13) 1816 in the 1(8) (year) of (His Life)
- 54 In Memory of WILLIAM WELLS Son of William & Eliz:Wells Who died March (-) 184(1 or 7) in the 28th year of his life.
- 55 In Memory of PENELOPE WELLS Daughter of William & Eliz: Wells who died Sept 15th 1822 in the 21 year of her life
- 56 Sacred to the Memory of WILLIAM WELLS who died Dec 10th 1819, Aged 66 years I know that my Redeemer liveth and that he shall stand at the latter day upon the earth. And though after M(Y) (1) kin. Worms destroy this body, yet in my flesh shall I see God. When I shall see for myself and mine eyes shall behold and not another. Job.19, Chap. 25, 26, & 27 verses. We brought nothing into this world and it is certain we can carry nothing out 1 / 6-7 The Lord gave and the Lord hath taken away. Blessed be the name of the Lord. Job.
- 57 K.W. In Memory of KATHARINE WELLS Daughter of Tho. and Mary Wells of this Parish Who died the

- 23rd Day of May in the Year of our Lord 1834 in the (---) year of Her age.
- 58 To the Memory of THOMAS WELLS Formerly of the High House in this Parish who died at Leamington Jan 22 1864 in his 80th year The Memory of the just is Blessed. In Memory of MAY the affectionate Beloved wife of Thomas Wells of High House in this Parish who died December 26th 1850 in the 65 year of her age
- 59 To the Memory of JOHN HAWKES Who died 11: Dec 1872 Aged 76 years. To the Memory of MARY HAWKES Wife of John Hawkes who departed this life January 4th 1846 Aged 46 years Thy will be done. Matt 6.C.V.10. In Memory of JOSEPH Son of John and Mary Hawkes Who died Nov 2 1847 Aged 23 years. In Memory of JOHN Eldest Son of John and Mary Hawkes who died Oct. 30 1867 Aged 45 years
- 60 J.H. 1869 W.C. In Affectionate Remembrance of JOSEPH HOPKINS Who departed this life June the 10th 1869 in the 45th year of his age. In all his dealings he is just in words and actions kind In God in life he put his trust on Him his hope reclined.
- 61 In Memory of THOMAS AVERN Who departed this (life) September (-----) Aged 58 --) Not an appointed time -) Also MARY AVERN Relict of the above who died Jan 29th 1844 (8)3 years
- 62 Sacred To the Memory of MARY Daughter of ROBERT and MARY MANDER Who departed this life November 2 1850 Aged 37 years.
- 63 Sacred to the Memory of REBECCA Daughter of ROBERT & MARY MANDER Who departed this life April 12th 1826 in the 16th year of her age. Also of ELIZ' TH. Sister of the above who departed this life Nov. 24th 1835 Aged 18 years. Forbear to weep my living friend for thee
- 64 Sacred to the Memory of ROBERT MANDER who departed this life Jan? 29 1848 Aged 77 years MARY Wife of Robert Mander who departed this life July 2nd 1836 Aged 62 years
- 65 RW (footstone)
- 66 RW (footstone)
- 67 In Affectionate Remembrance of JOHN TAYLOR who departed this life Oct 18th 1850 Aged 72 years Also of AMY wife of the above who departed this life May 25th 1878 Aged ()6 years.
- 68 Sacred to The Memory of WILLIAM TAYLOR of this Parish who departed this life November 20th 1828 Aged 8(1 or 7) Also of ANN his wife who departed this life July 8th 1816 Aged 65
- 69 (----) Memory of (----) Daughter (----) (TAYLOR) (----) this life (----) (1)9 years (-----) life (----) 1(-) years -) departed this life (----) aged 2(5) years departed this life 1820 aged 28 years (--) who departed this life June 28 1792 aged 1 year.
- 70 Sacred To the Memory of JOSEPH TAYLOR who died May 6 18 (--) Aged 73 years Also of (SUSANAH) his wife who died Dec 11 1855 Aged 59 years. Also of JOSEPH TAYLOR who died (-----) Aged 53 years
- 71 In Loving Memory of WILLIAM FREDERICK EVANS who died March 17th 1899 Aged 81 years. Also of SARAH EVANS Widow of the above who died June 1st 1902, Aged 83 years. "Thy will be done" At Rest
- 72 Sacred To the Memory of CHARLES SMITH who departed this life 24th of June 1850 Aged 24 years He ever had a gracious heart, His friends for him lament. His Memory will be ever blest, That's his best monument He was in life beloved and in death lamented.
- 73 In Affectionate Remembrance of GEORGE WARMINGTON who died February 16th 1882 Aged 63 years In the midst of life we are in death. Also of ANNE WARMINGTON Wife of the above who died August 20th 1902 Aged 82 years. At rest
- 74 Sacred to the Memory of JOHN FEATHERSTONE who died Aug 15th 1818 Aged 82 years Also MARY Wife of John Featherstone who departed this life January 13th 1831 in the 72nd year of her age.
- 75 In Memory of ELIZABETH WHITE Died Oct 8th 1880 Aged 2 years BERTHA WHITE Died Oct 13th 1880 Daughters of the late Job White
- 76 In Memory of SAMUEL WIL(-)ORE who died (---) 9 1813 aged (-)6 years.
- 77 Sacred to the Memory of JOSEPH WILLMORE Who departed this life May 29th 1830 in the 49th year of his age
- 78 JOSEPH ROE of this Parish who departed this life March 1st 1841 Aged 90 years ELIZABETH His Wife who departed this life March 11 182(-) Aged 7(-)
- 79 Sacred to The Memory of THOMAS ROE who departed this life April 15th 1829 Aged 70 years
- 80 In Memory of HENRY TAYLOR who departed this life June 5th 1880 Aged 100 years & 3 months MARY, the Beloved Wife of Henry Taylor of the Parish of Berkswell who departed this life August 21st. 1852 in the 71st year of her age With patience to the last she did submit and murmured not at what the Lord thought fit She with Christian courage did resign her soul to God at his appointed time

- 81 In Loving Memory of WILLIAM MOSELEY Died October 27th 1897 Aged 38 years What I say unto you, I say unto all, watch Also SARAH ANN Wife of the above Died Feb. 20th 1941 R.I.P.
- 82 In Loving Memory of WILLIAM WOODWARD who died Feb. 10th 1901 Aged 88 years Also of ELIZA WOODWARD Wife of the above who died Sep. 1st 1897 Aged 79 years
- 83 In Loving Memory of ALICE the beloved wife of CHARLES PALMER who died Sep. 3rd 1896 Aged 75 "Blessed are the dead which die in the Lord" Also of CHARLES PALMER Who died Jan. 11th 1898 Aged 75 He sleeps in Peace
- 84 Sacred to The Memory of JAMES AVERN who died March 14th 1827 Aged 69 years Also MARY ANN Relict of the above who died Feb. 25th 1844 Aged 89 years.
- 85 Sacred (To the) Memory (----) (-----) AVERN (---) (-----) his life
- 86 In Memory of THOMAS AVERN Who departed this life April 24th 1852 Aged 79 years Also of MARY ANN Wife of the above Who departed this life January 8th 1870 Aged 80 years He hath borne our grief and carried our sorrows
- 87 In Memory of MARY Wife of WILL. AVERN Who (died) November (-----) Aged (--) years Within this (---) wife (-----) iour
- 88 In Memory of WILLIAM AVERN who departed this life – 25 Aged 73 years
- 89 Sacred to the Memory of JAMES AVERN who departed this life February 15th 1808 Aged 34 years Life how short eternity how long Also MARY Daughter of the above departed this life April 6th 1801 Aged 17 months A husband good a father dear A faithful friend lies buried here With faith in Christ he takes his rest With joyful hopes of being blest.
- 90 Sacred To the Memory of AME Wife of THOMAS AVERN Who departed this life (-----) 7)fth (----) A A 1808
- 91 No inscription visible
- 92 Sacred To the Memory of CHARLES HANDLEY Late of Hockley House who departed this life on the 19th (----) 1835 Aged 63 years Also ELIZABETH Wife of the above Who died 2 Feb 1871 Aged 75 years With deepest thought Spectator view thy fate!
- 93 Sacred to the memory of EDWARD and CHARLES sons of THOMAS AND ELIZ' TH PALMER Edward died 9 Aug 1810 aged 10 years Charles died 29 Sep 18(5or3)7 aged 62 years
- 94 In Memory of THO. PALMER who died Apl. 10 1796 And Also ELIZABETH his wife who died Nov. 9 1799 Aged 66 Affliction sore long time I bore Physicians were in vain Till death gave ease when God did please And freed me of my pain.
- 95 Sacred to the memory of THOMAS son of JOHN & MARY PALMER who died 8th April 1837 in the 24th year of his age. A pale consumption gave the fatal blow The stroke was certain but the effect was slow All means were used but human skill was vain Till Christ the true physician eased my pain
- 96 Sacred to the memory of (JOHN) PALMER who died 11th Dec. 1837 Aged 72 years MARY PALMER who died 6 Dec 1859 Aged 77 years Praises on stone doth our ambition feed Let everyone to his own ways take heed What I have been and what you are The day of judgement will declare.
- 97 Here lieth the body of (----) REEVE who deceased) the (----) of (-----) Domy (-----) wife w(ho deceased) the(-) (day ---- An--) Domy
- 98 No inscription visible
- 99 In memory of WILLIAM TAYLOR late of Wroxhall who died 1 (Nov) 1853 aged 77 years Also MARY his wife who died 6 March 1833 aged 7(1) years
- 100 No inscription visible
- 101 No inscription visible
- 102 Here lieth the Body of THOMAS ASHWOOD Gentleman Departed the 5 day of April Anno Dom. 1684
- 103 In Memory of THEOPHILES daughter of JOHN AND ANN MIDDLETON She died (3 or 5) 18(7)6 aged (9 weeks) Also MARY ANN (-----) Daughter (-----) died (9th) March (1829)
- 104 Sacred to the memory of ANN wife of JOHN MIDDLETON (of Rowington) She departed this life November 11 1836 Aged 62 years.
- 105 Sister (---) love Who died (---- 1(3) (Nov) 188(3 or 5) (-----) -----
-- No more shall we (-----) (own) sister was (-----) not (deceased) This we should (-----) eternity Then does (-----) cease to mourn.
- 106 No inscription visible
- 107 In Memory of THOMAS GILBERT who died September 24 1854 aged 46 years

- 108 In Memory of DAVID son of ANTHONY and ELIZABETH HANSON who departed this life Sep. 1817 Aged 18.
- 109 No names visible
- 110 In Memory of DAVID GIBBS who died September 5th 1861 aged 35 years Belov'd and mourn'd; no art could save The will of Heaven appoints this early grave.
- 111 In Loving Memory of JOHN HANCOX who died June 20th 1877, Aged 57 years ELIZABETH REYNOLDS who died March 27th 1891 Aged 84 years. Also of ANN HANCOX who died Octr 8th 1898 Aged 66 years.
- 112 Sacred to the memory of CHARLES COCKES who departed this life June 22nd 1844 Aged 87 ELIZABETH wife of Charles Cockes who departed this life March 24th 1807 Aged 51 Be ye always ready for in such an hour (as) Ye think not, the final summons cometh
- 113 To the memory of ISAAC GREVES Died July 17 1875 Aged 79 years. MARY wife of Isaac Greves Who died 16 Aug 1857 Aged 62 years
- 114 Sacred to the Memory of ISAAC son of ISAAC & MARY GREVES of Wroxall Who departed this life • Jan'y 28th 1843 Aged 23 years Man like a flower & s(p)rings to light At morning pleasant to the sight Afternoon a blast cuts down the flower And man decays in one short hour
- 115 In Affectionate Remembrance of JOHN FETHERSTON Died April 17th 1890 Aged 85 years. Also MARY ANN FETHERSTON Who departed this life April 1st 1874 Aged 51 years
- 116 Sacred To the Memory of MARTHA wife of THOMAS FETHERSTON who died 31 March 1819 Aged 62 years. THOMAS FETHERSTON who departed this life 1 April 1872 Aged 82 years
- 117 To the memory of ANN FETHERSTON who departed this life October 28th 1859 Aged 52 years The toils of life and pangs of (---) And care and pain and sickness
- 118 Sacred To the memory of FRANCIS FETHERSTONE who died Feb'y 12th 1841 Aged 77 years Also of BETTY his wife who died Feb'y 3rd 1846 Aged 86
- 119 No inscription visible
- 120 In memory of MARY WILMIN who died July 1st 1876 Aged 53 years Beloved in life lamented in death
- 121 No inscription visible
- 122 In Memory of THOMAS (-)OLT who died April (-)1 Aged 86. HANNAH wife of Thomas who died M(----) 1808. (Lower inscription unreadable)
- 123 No inscription visible
- 124 In Memory of EDWARD EBORALL of this parish (farmer) who died October 2nd 1877 Aged 82 yrs. Also ELIZABETH wife of the above and daughter of WILLIAM AND SARAH FULFORD she died August 11 1865 Aged 68 years. Also WILLIAM FULFORD who died July 17th 1856 Aged 86 years. Also SARAH his wife who died November 21 1852 Aged 77 years "The hoary head is a crown of glory It be found in the way of Righteousness." Prov.xvi.31.
- 125 No inscription visible
- 126 Sacred to the memory of JOHN BR(-----) late of this (parish) who died the 28 Dec 1791 (----) And (-----) Now let us (-----) while (--) to (-----) eternity. Sacred to the memory of -----dbern) -----177-
- 127 (---) life January (Anno) dom 1693 (-----) the 66 yea- of his age 1691
- 128 Sacred (-----) of (-----) CLEMENT AVERN (-----) (11) of (January) 1777(6) aged (3-) years He departed this life on the (8th day) (---) of February 17(8-) Aged (8)6 M (-----bench----- ---ich--)
- 129 No inscription visible
- 130 Here lieth the Body of WILL'M AVERN Late of this parish (W)ho departed (this l)ife the 5th day (-----) 6. (Here l)ie the Body of SUSANNA the wife of WILLIAM AVERN of this parish who departed this life the (9th) day of July 1759 (-) the 69 year of (--) RIP. Age and sickness brought us home Unto the grave which all must come ... Both young and old prepare to dye In hopes to live eternally
- 131 In Blessed Memory of JANE FLORENCE the blessed daughter of JOHN & LUCY ASTON of Rowington Hall and Westfield Edgbaston who died on the 25th of February 18(74) "Jesus will take me"
- 132 (----)m(0-----) Rober(-----)(dep--- ----) 10th
- 133 MARK PETTI(T) Died Sept 9th(-----) Aged 9 years (----) the dead which (-----)
- 134 No inscription visible
- 135 Who give Day and Night The Lord (t)ook (d)elight.
- 136 No inscription visible
- 137 Sacred to the memory of THOMAS PETTIT who died Feb 9 1851 Aged 47 years -----also of-----

- ELIZABETH wife of Thomas Pettit who died May 20 1836 Aged 32 years. Also THOMAS their eldest son who died Aug 2 1842 Aged 21 years.
- 138 Sacred plot to the memory of JOHN PETTIT who died Feb 20 1828 aged 86 years. Also of MAY wife of JOHN PETTIT who died Aug 1 (1818) aged 68 years Also JOHN their son who died Nov 2(0) 1825 aged 11 years
- 139 All you who ---- (---) now (----- Repent in T(---) In my Youth (---)
- 140 Sacred to memory of EMMA MOORE
- 141 THOMAS MOORE who departed this life 28 Dec 1(-) Aged 61 years. As husband Father But for (---)
- 142 In Memory of WILLIAM JOSEPH the beloved son of WILLIAM AND CATHERINE CRAPPER who departed this life 12th April 1852 aged 5 years and 7 months "Thy will be done" Also MARY PICKETT sister of the above who died July 22nd 1879, aged 37 years She is not dead but sleepeth.
- 143 Sacred to the memory WILLIAM CRAPPER who departed this life March 16th 1880 Aged 64 years Into thine hand I commit my spirit thou hast Redeemed me O Lord God of Truth. Psalms . xxxi.V.
- 144 Sacred to the memory of SARAH the beloved wife of GEORGE BALL who departed this life April 26th, 1844 Aged 48 And the said GEORGE BALL who died Oct:1(-) 1853 Aged 58 years
- 145 In memory of EDWARD SHARMAN who died May 15th 1859 aged 55 years Also HANNAH SHARMAN wife of the above who died Dec 30 18(4)8 Aged (4)0 years
- 146 In memory of WILLIAM GARDNER who departed this life March 21 1818 (in the 63rd) year of his life MARTHA wife of (WILLIAM GARDNER) who departed this life Oct 6 1826 Aged 70 years
- 147 Memory of JOSEPH KING who died Jan 1 1827 aged 80 years. Also of ELIZABETH his wife who died June 19 1788 aged (5)1 years JOSEPH son of the above Died in his Infancy. Also of HANNAH his second wife who died Aug 25 181(0) aged (-)1 years SARAH Daughter of the above Died June (---) 1809 aged 11 years
- 148 To the memory of ISAAC NORTON Died Sept 3rd 1818, aged 84 And MARY, his wife Died August 16th 1818, aged 73 Also JOSEPH BURGE, Died Dec 24th 1836, aged 78 And ANN, his wife Died May 19th 1848, aged 78 Also REBECCA, their daughter Died May 7th 1815, aged 7 And ELEANOR, their daughter And wife of RICHARD NASH, Died Nov 18th 1847, aged 37 Also MARY, wife of SAMUEL FULLARD, and Daughter of JOSEPH JENKINS Died Nov 1st 1849, aged 56.
- 149 Footstone (displaced?) J.E.T / E.M.T.
- 150 In memory of MARY AMELIA RABIN, died July 19th 1897, aged 52, Also VICTOR CHARLES, died Sept. 10th 1903, aged 22 And JAMES RABIN died Aug 11th 1937, aged 92 "Resting where no shadows fall" And JENNIE & LIZZIE, buried in Canada
- 151 No inscription visible
- 152 In loving memory of THOMAS AVERN born July 4th 1823 died January 7th 1903 also HARRIETT wife of the above born January 31st 1825 died November 6th 1890. "Thanks be to God for His unspeakable gift"
- 153 In Loving memory of JOHN EDWIN TURTON who departed this life Jany 23rd 1897 in his 60th year "His end was peace" also of EVA MARY TURTON who departed this life July 12th 1893 aged 6 years & 9 months In the midst of life we are in death.
- 154 In Memory of WILLIAM TIBBITS who died at the Elms, Balsall November 12th 1896 aged 75 years In memory of JANE wife of WILLIAM TIBBITTS who died at the Elms Balsall 21st June 1887 aged 68 years
- 155 In memory of ANN daughter (of) WILLIAM and (---) late of Wroxall who died (----) aged 57 years. In memory of WILLIAM TIBBITTS late of Wroxall who died 22nd Sept. 1815 aged 77 years. In memory of JOHN son of WILLIAM & ANN TIBBITTS late of Wroxall aged 23 years Sacred to the memory of ANN TIBBETTS of Rowington Relict of the late WILL. TIBBITTS of Wroxhall who departed this life Dec 7th 1826 aged 75 years
- 156 In memory of CLEM(E)N(T) TIBBITTS son of WILLIAM AND MARY TIBBITTS who died 13th Dec 1821 aged 7 years
- 157 Memory of SARAH Daughter of WILLIAM & MARY TIBBITTS who departed this life April 24th 1837 in the 20th year of her age Each passing day are numbers ca(-----) sway And some so sudden, who've not t(----) to pray, Spend well your time, your precious(s---tos---ve) For no repentance is there until (I--- ave)
- 158 In memory of EL(----TIBB)ITTS (-----) Feb26th 1887 aged 61 years In memory of MARY daughter of WILLIAM & MARY TIBBITTS Died July 18th 1867 aged 43 years Sacred to the memory of MARY TIBBIT(TS- ---) ton (----wi-----TIBBITTS of W(-----) who departed this life Feb y 1 1849 aged 57 years. Sacred to the memory of WILLIAM TIBBITTS who died Sept 9th 1844 aged 67 years
- 159 In affectionate remembrance of CAROLINE OSBORN who died October 21st 1874 aged 12 years also of ELEANOR OSBORN who died October 21st 1874 aged 10 years Also of JOSEPH OSBORN - who died

- October 24th 1874 aged 8 years and 11 months also of MARY JENKINS OSBORN who died October 26th 1874 aged 8 years The beloved children of JOSEPH AND CAROLINE OSBORN of Rowington. In loving memory of JOSEPH OSBORN who died November 13th 1881 aged 65 years also of CAROLINE ADELAIDE widow of the above who died November 26th 1892 aged 64 years "Until the day break" In memory of JOSEPH OSBORN who died January 16th 1866 aged 78 years. Also of ANN the wife of JOSEPH OSBORN of Lapworth Youngest daughter of JOSEPH JENKINS late of Lapworth and Water Orton in this County who died January 7th 1837 Aged 61 years.
- 160 In Loving Remembrance of WILLIAM HIBBERD of Rowington Mill late of Birmingham who entered into rest September 3rd 1884 Aged 60 years In the midst of life We are in death.
- 161 In Loving memory of ERNEST only son of VINCENT & ANNIE SCHOLEFIELD Born November 25 1872 Died March 9 1885 "He shall feed His flock like a shepherd, He shall gather the lambs with His arm, And carry them in his bosom."
- 162 In Loving memory of JOHN ASTON, of Westfield Edgbaston, and Rowington Hall, Esquire, J.P. Son of SAMUEL ASTON, of Rowington Hall He departed this life Sept. 12th 1882 Aged 81 years. Thou O Lord God are the thing that I long for Thou art my hope, even from my youth. In memory LAURA, widow of the said JOHN ASTON Esq. Daughter of the late JOHN MEREDITH Esq. of Leamington Departed July 10th 1890, Aged 87 years. My God shalt make my darkness to be light.
- 163 No inscription visible
- 164 In memoriam ANNIE Youngest daughter of WILLIAM BETTS Esq of Leamington, Who departed this life May 15th 1888 "I am the Resurrection and the Life."
- 165 In Memoriam CAROLINE Daughter of WILLIAM BETTS of Leamington who departed this life 2nd June 1898 R.I.P.
- 166 In Affectionate Remembrance of EDWARDS HAWKES (late of Rowington) who died at Warwick January 21st 1877 Aged 39 Years Come unto me all ye that labour and Are heavy laden and I will give you Rest. Matthew 11 Chap 28 Ver.
- 167 In Affectionate Remembrance of OLIVIA MASTERS Who died June 24th 1874 Aged 24 years Also of MARY WALLIS Widow of the late WILLIAM WALLIS of Berkswell who died January 2nd 1874 her 88th year And of THOMAS WALLIS Died Feb 6th 1892 Aged 74 years. Also of FRANCES FRENCH of Canley Who died April 4th 1877 Aged 47 Also of WILLIAM WALTON WALLIS of Beechwood Berkswell Who died October 30th 1886 In the 74th year of his age.
- 168 In Memory of Mary widow of the late EDWARD THOMPSON Esq. of Shrewsbury and daughter of the Rev. GEORGE WEAL Former vicar of this parish. She died (-----) 1873 Aged 80 years.
- 169 In Hope of Eternal Life In memory of FRANCIS PLANT Born March 31:1796 Died June 11:1869 Clerk of this parish 23 years.
- 170 Not lost but gone before To the memory of Our beloved BENJAMIN, MARTHA HENRY PLANT and FREDRIC WINDRIDGE
- 171 Jesu Mercy HENRY GOULD Fell asleep in Jesus 22nd January 1871
- 172 In Memory of RICHARD MIDDLE(-- who died Feb 1(-- Aged 66 years Also R(H)ODE(----- EDWARD MIDDLE-- who died (---- Aged 61
- 173 In Memory of Ed(-----)idin ETON Late of Pinley Abbey who died 29th Nov 1810 Ag(-----) Years
- 174 Memory of Mrs SARAH MOSELEY who died the 25 Feb. 1853 Aged 61 years
- 175 Sacred to the Memory of JOSEPH LEA Who departed this life (---) the 6th of Oct. 1858 Aged 76 years Also MARY wife of JOSEPH LEA who departed this life 25th Day of July 18(4)8 In the 71st year of her age. She distinguished herself By active kindness to the (-) poor Combined with just integrity And deeply regretted by all To whom her faithful attachment Has rendered her dear.
- 176 JOHN LEA Who died April 3rd 1806 Aged 75 Also SUSANNAH his wife Who died Oct.1.1803 Aged 71
- 177 Sacred to the memory of WILLIAM COOKES who departed .this life November 15 1828 aged 91 If all things Yet save thy Soul Mark III 6.37.
- 178 HERBERT Born Decembe (r-----) Died Nov(-----) 1(7)9(8) ANNE his wife Born Feb Died Mar ---) 180(3)
- 179 Sacred To the memory of JOSEPH KENDRICK who died March 1.1822 Aged 45 years Also THOMAS son of JOSEPH & ANN KENDRICK Who died March 14th 1814 in the 3rd year of his age
- 180 Sacred to the memory of PETER STEAD Who died Oct. 8th 1808 Aged 61 years Also ANN his wife and relict of JOSEPH KENDRICK who died June 18th 1822 Aged 54 years
- 181 No inscription visible

- 182 Sacred to the memory of MARY ANN BARNETT Nov 2nd 1852 Aged 19 years
- 183 Sacred to the memory of JAMES HENRY son OF JAMES (AND MARY) BARNETT who died (-----) 20th 1826 (----) (Also) JAMES their son Who died April 2 1837 Aged 2 years
- 184 In memory of (JOHN) STEAD who departed this life (-----h) 1812 Aged (--) years
- 185 Sacred to the memory of JAMES BARNETT who departed this life July 16 1811 Aged 11 years Also of MARY wife of the above who died Dec 1(-) 1839 Aged 39 years
- 186 In memory of CAROLINE widow of WILLIAM BRADBURY died July 9th 1878 Aged 56 years.
- 187 WILLIAM BRADBURY who died 9th April 1869 Aged 76
- 188 In Loving Memory of FANNY the beloved wife of ARTHUR E SMITH (of Quarry Farm) who died August 1 1894 aged 40 years In the midst of life we are in death
- 189 In Memory Of MARY widow of the late JOHN MEACOCK who died April 25 1888 aged 79 years Come unto me ye weary I Will give you rest
- 190 Revd John Gwyn Davies 13.12.1912 to 26.06.2006 A powerfully gentle man. Olive Elizabeth Davies 18.06.1920 to 13.06.2006 A lady of inexhaustible youthfulness. Beloved parents to Stephen, Peter and Michael.
- 191 JOHN WILLIAM RYLAND, J.P., F.S.A., 1856-1928. Also his wife JANE born March 11th 1860 died February 6th 1935.
- 192 Muriel Elizabeth Ryland beloved wife of Llewelyn Madeley Ryland died 9 Aug 1964 age 70, also Llewelyn Madeley Ryland died 6 Oct 1972 age 87
- 193 RAYMOND ALEXANDER CORBETT, ALEC, 25 September 1902, 20 January 1961, Vicar's Warden 1951 - 1961. One start differeth from another star in glory 1 Cor 15.41. Mary Corbett 20th march 1910 11th February 2005
- 194 Loving memory of ALBERT WILLIAM EVERITT born August 26th 1872 died October 18th 1955. Also HELEN MAUD EVERITT born August 27th 1878 died February 5th 1958.
- 195 MARY AUGUSTA MEREDITH wife of CHARLES MADELEY died March 27th 1921 age 48 years.
- 196 In memory of THOMAS FREDERICK SMITH died 29 September 1950 aged 82 years. Also of his beloved wife ANN JENKINS SMITH reunited 13 July 1954 in her 95th year. Also their son ALBAN WILLIAM SMITH died 25 December 1975 aged 77 years. In memory of OSBORN THOMAS SMITH fell in action in Egypt 23 April 1916 aged 25 years. JOSEPH FREDERICK SMITH died 21 January 1940 aged 43 years. SYLVIA OSBORN SMITH died 3 October 1937 aged 6 years. STEPHEN died in infancy. VIOLET IRENE SMITH died 3 June 1983 aged 75 years. JANE JENKINS CHAPMAN Died 2nd June 2013 Aged 76 years. JOHN CHAPMAN (Jack) Died 18th February 2014 aged 85 years
- 197 SAMUEL LINGARD 21 May 1923 aged 62 years. Also his wife SARAH ELIZABETH died 10 April 1966 aged 95 years. Younger daughter HILDA BERTHA TAYLOR 1908-1964.
- 198 Enoch Smith died Mar 16 1916 Age 86. Also of Caroline Smith died Feb 13 1936
- 199 JOSEPH JOHNSON husband of FANNY LUCY died January 14th 1914 age 68 years. Also FANNY LUCY JOHNSON died June 16th 1924 age 70 years.
- 200 In loving memory of EDGAR LLEWELLYN EDWARDS April 14th 1871 - December 30th 1943 and of his wife MARGARET ANN March 29th 1875 - August 20th 1947 of The Croft, Rowington.
- 201 FRANCIS THEODORE CHRISTOPHERS of Ribbons, Rowington, February 26th 1903 - November 3rd 1945.
- 202 HENRIETTA FRANCES CURRALL born January 3 1873, died November 10 1938. ALFRED WILLIAM CURRALL born December 22 1872 died April 19th 1951. THOMAS CLARK HANCOCK born 25 May 1897 died 8 October 1970. Josephine Eugenie Hancock 1 Jan 1898 - 23 Dec 1984.
- 203 JOAN BEECHING STEPHENS died 14 June 1946 aged 37 years. LEON EDGAR STEPHENS died 24 January 1977 aged 76 years.
- 204 ALICE WILMINA HITCHCOCK ORCUTT born December 13 1862 died January 1st 1939. HARRY FREDERICK LEE ORCUTT born June 12 1861 died May 17 1942. RALPH HITCHCOCK ORCUTT born January 4 1903 died January 18 1975.
- 205 To the memory of EDWIN FRANCIS REYNOLDS 1875-1949, his beloved wife GERTRUDE MABEL 1885-1952.
- 206 In loving memory of a dear husband and father NORMAN TOM BUSBY born 19 December 1898 died 15 May 1955.
- 207 HUBERT EDWARD WILSON of Shakespeare Hall, Rowington, born November 28 1880 died April 26 1942. Also his wife ELLEN CONSTANCE born November 18 1880 died December 10 1957. Lt Col Edward

- Chesshire Wilson, Shakespeare Hall Rowington, Born May 30th 1907 died November 25th 1985
- 208 CLIFFORD LAKIN SMITH died 17 August 1955 aged 77 years, and his wife MARGUERITE died 27 June 1969 aged 88 years.
- 209 In loving memory of PHILIP JOHN MORLEY died 11 April 1954.
- 210 In remembrance of HERBERT McWILLIAMS died 31 March 1960 in his 76th year. Schoolmaster and Lay Reader of this parish, and of his wife ELSIE ELIZABETH died 3 May 1977 aged 88 years.
- 211 In memory of WILLIAM JOHNSON of Quarry Farm who died 12 February 1950 aged 72 years, also his beloved wife ANNIE reunited 26 May 1958 aged 85 years.
- 212 Loving memory of EVELYN MAY HOPCROFT died November 16th 1960 age 68 years also CHARLES HOPCROFT died April 9th 1967 age 77 years. Clifford John Charles Hopcraft 3.9.21 - 20.4.2002. Darwin Kyte beloved wife of Edith 11.9.14 - 16.9.2006
- 213 Henry Priest, Harriet Priest
- 214 MARY ANN SLY born September 14th 1841 died October 7th 1908, also her husband WILLIAM SLY died March 6th 1929 age 86 years. Interred at Budbrooke.
- 215 FREDERICK WILLIAM SLY born January 23rd 1871 died April 15th 1901. Also of SARAH his wife died February 15th 1919 age 52 years.
- 216 ANNIE PRIEST wife of CHARLES J. PRIEST of Birmingham died January 8th 1903 age 46 years. Also CHARLES J PRIEST died March 11th 1922 age 69. Also their eldest son FRANK PRIEST of Birmingham died October 16th 1951 age 69 years. Loving memory of LAURA PRISCILLA PRIEST wife of FRANK PRIEST died September 30th 1965 age 86 years also ELEANOR PRIEST daughter of CHARLES JOHN PRIEST died July 6th 1969 age 82 years.
- 217 Loving memory of BENJAMIN WILLIAM WESTWOOD born April 29th 1856 died December 28th 1902 also SARAH GERTRUDE WESTWOOD widow of above born July 22nd 1856 died March 10th 1915 also HOWARD their son born September 15th 1883 died October 7th 1914 interred at Littleham-cum-Exmouth, Devon.
- 218 Loving memory of MARTHA beloved wife of CHARLES JOHN PRIEST died March 16th 1903 age 76 years. Also CHARLES JOHN PRIEST died February 4th 1907 age 76 years.
- 219 THOMAS BARNETT died August 26th 1902 age 59 years. Also SARAH ANN wife of above died August 5th 1912 age 59 years, also WILLIAM their son died December 28th 1908 age 27 years.
- 220 Loving memory of GLADYS MAY TODD died November 11th 1903 age 2 years 3 months also her sister ELLEN ELIZABETH died September 24th 1973 age 76 years.
- 221 Loving memory of AGNES wife of ERNEST OLIVER of Kingswood died August 31st 1914 age 47 years.
- 222 Loving memory of JAMES MOORE died September 17th 1910 age 54 years, also his beloved wife AMELIA MOORE died July 30th 1940 age 84 years. RUTH daughter of JAMES & AMELIA MOORE, wife of Lieut. Col. Rev. R.M. PILBEAM born 4th November 1894, died May 1955.
- 223 Loving memory of EDWARD SHAW COOPER died 13th February 1909 age 28 years.
- 224 JANE SPENCER died March 20th 1915 age 63 (remainder illegible~)
- 225 Loving memory of ELIZABETH wife of JOHN MANDER died at Finwood January 2nd 1916 age 72 years. Also JOHN MANDER died at Lowlands October 9th 1941 age 89 years.
- 226 Loving memory of WILLIAM SMITH died April 2nd 1916 age 84 years, also his beloved wife ELIZABETH SMITH died January 27th 1931 age 85 years, also WILLIAM HENRY son of WILLIAM & ELIZABETH died March 5th 1942 age 71 years
- 227 EDITH MAY RAY beloved wife of E.P. RAY and dear mother of DONALD born March 3rd 1892 died April 26th 1919.
- 228 Loving memory of SARAH ELIZABETH GLAZE died October 23rd 1919 age 42(?)
- 229 Loving memory of ANNA MARIA beloved wife of WILLIAM BRANSON died December 27th 1919 age 52 years.
- 230 WILLIAM JAMES KEMBER died January 27th 1920 age 67 years.
- 231 Loving memory of THOMAS MEIGH died October 10th 1920 age 75 years.
- 232 ELEANOR wife of JAMES ARTHUR died February 11th 1911 age 55 years of Henley-in-Arden.
- 234 CHARLES FAIRFAX wife of ELIZABETH died November 3rd 1918 age 68, also ELIZABETH wife of above died March 6th 1929 age 85.
- 235 SARAH WOOD died March 5th 1910 age 93 years. Also MARIA wife of HENRY ALLEN died October 19th 1929. (no age)

- 236 EMMA JANE wife of CHARLES GHENT died April 20th 1911 age 63 years. Also CHARLES GHENT born May 1st 1842 died November 4th 1933.
- 237 WILLIAM BEECHAM died November 13th 1918 age 85. Also LEVINIA his beloved wife died April 25th 1911 age 71 years.
- 238 LUCY wife of JOSEPH BEECHAM died December 23rd 1932 age 72 years. Also JOSEPH BEECHAM died April 26th 1941 age 80 years.
- 239 In dear memory of ELIZABETH LANE who died October 26th 1918 aged 68 years. In memory of ISAAC LANE November 5th 1946 aged 83 years.
- 240 110204 Private E.G. MOORE, Labour Corp, 23rd November 1918 aged 25 years. [941]
- 241 George Kettle [1141]
- 242 In loving memory of our darling son FREDERICK MICHAEL MUMFORD died 5 December 1943 aged 2 years.
- 243 Edwin Sly
- 244 In loving memory of MARY LINZEY died January 3rd 1933 aged 13 months. Also of BOBBY.
- 245 ANTHONY HANSON February 15 1901 aged 68 years. Also MARY ANN wife of the above January 11 1924 aged 81 years. In loving memory of the joyous and courageous spirit of ANTHONY FRANCIS HANSON 8.6.22 - 9.6.95
- 246 In loving memory of AMY ANN GRESWOULD EDGE COX of Bushwood House, Rowington, died January 31st 1904 age 75 years. Also JOHN EDGE COX died March 8th 1905 age 74 years.
- 247 Lucy Catherine Mann [1204]
- 248 In loving memory of ANNIE MOSELEY died 27 March 1962 aged 73 years, the beloved wife of WILLIAM HENRY MOSELEY died 22 September 1962 aged 82. [1441]
- 249 JOHN THOMAS READ died 8 April 1980 aged 85 years and his wife Elsie died 9 Nov 1986 Aged 90. [N13]
- 250 JAS. PRITCHARD-GORDON 10 September 1937 - 19 February 1979. [N9]
- 251 In affectionate remembrance of MARY wife of THOMAS CORBETT who departed this life September 18th 1903 aged 45 years. Also of THOMAS CORBETT who died October 31st 1927 aged 70 years. [766]
- 252 In memory of CAROLINE BROWN widow of JAS. BROWN of Handsworth who died at Kingswood March 22nd 1900 aged 87. [706]
- A1 ELEANOR JULIA beloved wife of PERCY WILLIAM ALLDAY of Solihull born July 24th 1876 died November 29th 1930. Also PERCY WILLIAM ALLDAY of Solihull born June 24th 1882 - April 7th 1937. [1100, 1170]
- A2 Also AUGUSTA SOPHIA WALKER died January 11th 1922 age 76 for 52 years beloved wife of ALFRED RODEN WALKER of Lapworth. Also ALFRED RODEN WALKER died June 11th 1923 age 77. [1015]
- A3 EDITH wife of PERCY RUDGE of Warwick died February 3rd 1926 age 47 years. A beloved daughter, wife and mother. Also PERCY RUDGE died November 17th 1961 age 84 years [1042]
- A4 RODEN PERCY ALLDAY eldest son of WILLIAM & ELEANOR JULIA ALLDAY of Solihull born May 24th 1909 died at Clifton College March 15th 1926. [1043]
- A5 William Robert Ives [1044]
- A6 MAUD MARY BADGER died May 1st 1926 age 48 years. [1046]
- A7 Loving memory of JOHN DUTSON COUSINS died February 14th 1927 age 31 years. Also his wife CONSTANCE MARY died 1981 age 83 years. [1054]
- A8 John Horton Weetman [1055]
- A9 Loving memory of our dear mother ELIZA WRIGHT passed away August 20th 1927 age 73 years. [1058]
- A10 Walter Adams [1063]
- A11 Dinah Clews [1064]
- A12 EMMA JANE WHITFIELD died December 13th 1927 age 57 years. [1065]
- A13 Loving memory of VIOLET MUMFORD died February 18th 1928 age 19 years. [1067]
- A14 MARY AVERN died June 18th 1941 age 86 years. Also beloved husband JOHN died June 10th 1928 age 74 years. [1073, 1228]
- A15 CAROLINE ANN MITCHELL of Lyons Farm in this parish for 32 years died at Kingswood Farm, Lapworth, October 1st 1928 age 69 years. [1075]
- A16 MARY ANN FLORIDAY died October 28th 1928 age 87 years. [1076]
- A17 WILLIAM GOLD died September 1st 1928 age 78 years. (Remainder illegible) [1074]
- A18 Louisa Linforth [1077]
- A19 Edward Gold, Emma Gold [1085, 1116]

- A20 Loving memory of GEORGE HENRY PRUE departed this life September 19th 1900 also MARY his beloved wife departed this life October 20th 1929 age 71 years. [1087]
- A21 THOMAS GALLIMORE, L.R.C.D, L.R.C.S. born November 8th 1849 died November 1st 1929. Also his beloved wife ETHEL ROSE born March 27th 1869 died September 3rd 1950. [1089, 1321]
- A22 Loving memory of my dear husband HORACE WIGGETT died 19th October 1975 age 72 years. Also his brother ERNEST died 8th January 1936 age 23 years. Also their brother ARCHIBALD died 25th October 1982 age 73 years. [1090, 1588, N98, N99, N295]
- A23 Mary Ann E Hancock [1091]
- A24 Loving memory of our dear parents JAMES POWELL passed away July 17th 1930 also his wife MATILDA POWELL passed away June 15th 1970. [1092, 1541]
- A25 Loving memory of FANNY ELIZABETH beloved wife of ALBERT SMITH fell asleep July 20th 1930 age 55 years. [1093]
- A26 Evelyn Wallis [1094]
- A27 Sarah Heath, Samuel Heath [1095, 1135]
- A28 Alfred Worwood [1096]
- A29 John Rowney [1097]
- A30 In loving memory of MARY ANN LANE fell asleep September 15th 1930 aged 73 years. [1098]
- A31 Arthur Weetman [1099]
- A32 Walter Woodward [1082]
- A34 Unknown
- A36 Edmund Rupert Hopson, (child)
- AA1 Loving memory of MARY LUCY HEMMING 1872-1920 also FLORENCE SARAH MERRIMAN 1883-1949 [968, 1312]
- AA1 Loving memory of MARY LUCY HEMMING 1872-1920 also FLORENCE SARAH MERRIMAN 1883-1949
- AA2 Branson
- AA3 Loving memory of KITTY beloved wife of Rev. E.E. OLIVER died April 24th 1921 age 45 (?) [980]
- AA4 Loving memory of my beloved husband WILLIAM JOHN NICHOLS died May 21st 1922 age 62 years, also SEPTIMA NICHOLS died 12th June 1937 age 82 years. [998]
- AA5 Woolloff or Weetman?
- AA6 Loving memory of JAMES WILLIAM INGRAM died December 20th 1922 age 72 also LEAH beloved wife of JAMES W. INGRAM died April 17th 1925 age 87. [1036]
- AA7 Loving memory of HENRY ADAMS died January 11th 1923 age 27 years.
- AA8 Richard Priest [1011]
- AA13 Sarah Ann Reeve [1029]
- AA14 Loving memory of ISAAC WORCESTER KELLER died November 22nd 1924 age 62 years. [1030]
- AA15 Loving memory of RICHARD HENRY DRAPER died December 6th 1924 age 65 years, also his beloved wife EMMA died March 30th 1935 age 86 years. [1031, 1048]
- AA16 Loving memory of SARAH beloved wife of WILLIAM GOLD died March 21st 1925 age 80 years. [1034]
- AA23 Amos Boyles, H White [1049]
- AA23 Amos Boyles, H White
- AA24 MARY JANE TURTON died January 7th 1927 age 78 years. Our dear mother. [1052]
- AA29 In loving memory of JOYCE ROSEMARY BUNN died 9 March 1941 aged 1 year 4 months. In memory of our daughter BETTY JOAN GREEN died 16 June 1940 aged 7½ years. [1210, 1222]
- AA29 In loving memory of JOYCE ROSEMARY BUNN died 9 March 1941 aged 1 year 4 months. In memory of our daughter BETTY JOAN GREEN died 16 June 1940 aged 7½ years.
- AA30 In loving memory of SARAH ROGERS died May 28th 1927 aged 91 years. [1056]
- AA31 Loving memory of EMILY GRICE died May 12th 1926 age 41 years. [1047]
- AA36 Taylor, (child)
- B2 William Branson [1108]
- B3 Ethel Gertrude Insley, Frederick Gordon Insley [1110, 1180]
- B4 In loving memory of WILLIAM MOON NEWTON born March 10th 1866 died May 9th 1932. Also his widow ANNIE ELIZABETH NEWTON died November 16 1942 age 80 years. [1111, 1245]
- B5 William Westwood [1109]

- B6 George Henry Badger, Eliza Ann Badger [1195, 1112]
- B7 In loving memory of our dear mother MARY ANN PAGE who fell asleep June 6th 1932 aged 69 years. [1113]
- B8 In loving memory of THOMAS WAKNELL died November 21st 1932 aged 76 years. Also ANNIE his beloved wife died February 24th 1934 aged 73 years. [1119, 1138]
- B9 Dora Jessie Dean [1120]
- B10 Ellen Frances Priest [1124]
- B11 Eliza Priest, Oliver Priest [1125]
- B12 George Wiggins, Emily Wiggins [1129]
- B13 Helena Mary Allen, John Allen [1131, 1311]
- B14 Ellen Sweetman, William Avery Sweetman [1133, 1139]
- B15 CHARLES MORLEY died August 25th 1934 aged 81 years. [1140]
- B16 Ellen DONNELLY born June 1st 1854 died January 23rd 1935. [1143]
- B17 Florence Veale [1144]
- B18 Charles Wilkins [1146]
- B19 Eliza Barlow [1147]
- B20 In loving memory of ANN HUTCHINSON born May 5th 1868 died April 19th 1935, also HELEN ROSE HUTCHINSON born 29th January 1873 died 29 November 1956. [1150, 1383]
- B21 SA Avern, Thomas Avern [1153]
- B22 In loving Memory of Betty (Urn) [1156, N265]
- B23 WILLIAM CHARLES KIRBY died June 4th 1935 aged 75 years also of CLARA MARIA KIRBY died January 12th 1944 aged 77 years. [1158, 1256]
- B24 Thomas Edward Harris [1157]
- B25 In loving memory of JAMES SMITH November 8th 1935 aged 56 years. [1154]
- B26 Thomas William Whyman [1152]
- B27 In loving memory of dear son and brother BERNARD VICTOR WALLACE died June 29th 1935 aged 21. [1151]
- B28 Daisy Cooper, Emily Cooper [1126, 1209]
- B29 Jane Dumbleton? [1117]
- B30 Lillian Ruth Bladon [1114]
- B31 In loving memory of GEORGE HOPCRAFT died February 14th 1931 aged 83 years. Also ELIZABETH HOPCRAFT died March 16th 1943 aged 91 years. [1105, 1246]
- B32 Sarah Ann Soden [1102]
- B33 George Joseph Eggleton [1101]
- C1 JOHN AUSTIN died 22 September 1965 in his 90th year. JOHN TYRELL AUSTIN Sergeant R.A.S.C. died February 1st 1940 aged 21 years. [1203, 1485]
- C2 MAGGIE AUSTIN died 16 March 1975 aged 97 years, RONALD WRIGHT AUSTIN died 3 March 1975 aged 67 years. [1576, 1577]
- C3 Sacred to the memory of DEBORAH only daughter of EDWIN and HILDA FARDON died April 12th 1940 aged 22 years, and of their younger son DAVID FOWKES FARDON, R.A.F.V.R., killed on active service January 17th 1941 aged 18 years. [1208, 1218]
- C4 Also of their father EDWIN FOWKES FARDON born January 13th 1878 died November 23rd 1946, and of their mother HILDA FARDON born February 5th 1886 died February 23rd 1962. [1282, 1438, N270]
- C5 Leonard Arthur Allen, Alice Allen [1207]
- C6 In loving memory of SARAH INGRAM who died March 19th 1940 aged 82 years. [1206]
- C7 In loving memory of EDWIN CHARLES SLY who died October 24th 1939 aged 64 years. (broken stone) [1200, 1283]
- C8 Nellie Gurden [1199]
- C9 In loving memory of ALFRED TEALE who passed on September 8th 1939 aged 41 years. In loving memory of CONSTANCE WINIFRED TEALE who passed on August 2nd 1947 aged 42 years. [1198, 1289]
- C10 Eliza Priest, Samuel? Priest [1125, 1167]
- C11 Frederick William Mumford [1197]
- C12 John William Pickering [1196]

- C13 Arthur Edwin Tovey, JF Tovey [1194]
- C14 To the dear memory of HARRY WHITEHEAD who died March 10 1939 aged 72 years, also of FANNY wife of the above who died October 30 1942 aged 71 years. [1192, 1244]
- C15 In loving memory of THOMAS HARBON who passed on November 11th 1938 aged 70 years, also AMY ELIZABETH HARBON died September 15th 1945 aged 76 years. [1190, 1273]
- C16 John Hewitt [1187]
- C17 In loving memory of FRANCIS JOHN MALINS who died 25th April 1938 aged 67 years, and his wife MARY ELIZABETH MALINS who died 22 December 1962 aged 88 years. [1185, 1448]
- C18 William Henry Payne [1183]
- C19 In loving memory of RICHARD BETTS who died March 12th 1938 in his 75 year. Also his beloved wife SARAH reunited March 1st 1967 aged 94 years. [1182, 1500]
- C20 In loving memory of Lieut. Col. WILLIAM WARD, O.B.E., R.E.A.T.A. 6 May 1879, died September 1st 1937, and of his beloved wife EUNICE HIRST born March 28th 1888, died July 20 1965. [1178, 1481]
- C21 Richard Harris, Elizabeth Harris [1176, 1188]
- C22 Charles F Woodward [1174]
- C23 William Henry Meanley [1173]
- C24 James Draper [1172]
- C25 Albert Brittain, M Brittain [1171]
- C26 In loving memory of ALFRED WEBB who died 29 March 1937 aged 87 years. [1169]
- C27 Thomas Palmer [1166]
- C28 Emily Jane Walden [1165]
- C29 George Bunn, Mrs Bunn [1164]
- C30 Jane Neale [1163]
- C31 Charles Taylor, W Taylor [1162]
- C32 Ellen Matilda Sweetman, John James Sweetman [1161, 1303]
- C33 William Bragg, Harriet Bragg [1159, 1202]
- C34 E Eggleton
- C35 Jonathan Paul Booth, (child)
- CREM1 WILLIAM PALMER 9 January 1979 aged 84 years. [N8]
- CREM2 In loving memory of HENRY SAMUEL HARRISON 1903-1977.
- CREM3 In loving memory of ETHEL MARGARET HARRISON 1907-1977.
- CREM4 In loving memory of MICHAEL-LEONARD CHESHIRE died 6 July 1976 aged 30 years.
- CREM5 In loving memory of JOHN HALL COCKS died 24 April 1976 aged 69 years.
- CREM6 ROBERT PARKER 13 June 1980 aged 74. [N16]
- CREM7 ERIC ERNEST WIMLETT 1904-1975.
- CREM8 Unknown
- CREM9 In loving memory of RICHARD FRANCIS WILLIAMS died 22nd August 1965 aged 77 years, also his wife EMILY who died 12 June 1968 aged 81 years.
- CREM10 WILLIAM EDWARD ALLEN REDFEARN died December 7th 1970 also his wife EDITH died May 14th 1974.
- CREM11 Jonathan Paul Booth
- CREM12 Edmund?
- CREM13 Jean Hatton [1561, N132]
- CREM14 In loving memory of JOHN HAROLD DYSON 1890-1973 also his wife BEATRICE 1888-1966.
- CREM15 Dorothy, Denis, Gerald Hamilton Shaw
- CREM16 In loving memory of MAY OSTINS who died 15 March 1964 also JOHN OLIVER OSTINS who died 21 December 1976.
- CREM17 Loving memory of ANNIE LEIGH died January 6th 1965 age 87 years.
- CREM21 Lilian Turner + Alfred John Turner
- CREM22 Brian R Edwards
- CREM23 Mabel Parker
- CREM24 John Douglas Jarvis
- CREM25 Peter Joseph Kelland + Beryl Iris Kelland

CREM26 Edgar James Petty + Win Petty
 CREM27 Leonard Arthur Woodall + Mary Gladys Woodall
 CREM28 Herbert Leonard Chesshire
 CREM29 Elizabeth Mary Mould
 CREM30 Arthur Smith + Mary L Smith
 CREM31 Alfred Genever Boggust + Sadie Boggust
 CREM32 John Eric Rowe + Dorothy Rowe
 CREM33 Ronald Brain + Lilian Emily Brain
 CREM34 Joanne Megan Coop + Alice + Geoffrey George Coop
 CREM35 James Arthur William Dilley +_ Violet May Dilley
 CREM36 Elizabeth Anne Harvard Scholfield + John Hensley Folley
 CREM37 Graham John Sheenan
 CREM38 Carol Ann Easton
 CREM39 Elsie May Evans + James Moses Evans
 CREM40 Philip Hurst Picton Hill + Amy Lillian Hill + Elizabeth Hill
 CREM41 Thomas Stephen Fell + Amy Lillian Fell
 CREM42 Grace Audrey Collins + Roland Henry Collins
 CREM43 Betty Beatrice Bainbridge
 CREM44 Peter John Cocks
 CREM45 Joseph Charles Beck + Sheila Evelyn Beck
 CREM46 Elizabeth Winifred Clarke-Williams
 CREM47 John A Coleman + Yvonne Coleman
 CREM48 Paul Johnson + John F Johnson + Frances Dolly Johnson
 CREM49 Norman Cole
 CREM50 William Michael Swain
 CREM51 Janet Mary Hale
 CREM52 John Seddon
 CREM53 Arthur + Brenda Watson
 CREM54 Pietro Canto
 CREM55 Geoffrey Edwards
 CREM56 Neil John Smith
 CREM57 Eric John Wilcox
 CREM58 Eunice Dorothy Wilkes + Duncan Charles Wilkes
 CREM59 Kathleen Peebles
 CREM60 Alan Kevin Appleby
 CREM61 Ivor Johnson
 CREM62 Marilyn Johnson
 CREM63 Josephine Anne Cox
 CREM64 Paul Lickorish
 CREM65 Josephine Anne Woodall
 CREM66 Roy Edward Fisher
 CREM67 Jean Clarke
 CREM68 Crescent Margaret Roberts
 D1 Loving memory of OSYTH LOUIS beloved wife of JOHN ORTON HOLLIICK born July 2nd 1896 died February 9th (?) 1959. [1205]
 D2 Ann Bailey [1213]
 D3 Edwin Charles Francis [1215]
 D4 Lydia Meanley [1216]
 D5 Mary Pendleton [1217]
 D6 Ann Elizabeth Clarke [1220]
 D7 William Henry Tovey [1224]

- D8 Arthur James Viggers [1225]
- D9 In loving memory of FREDERICK JOB WHITE who passed away June 6th 1941 aged 81 years. Also ALICE WHITE who died January 25th 1952 aged 85 years. [1226, 1342]
- D10 Fannie Elizabeth Skinner, E Skinner [1227]
- D11 In loving memory of ANDREW RICHARDSON beloved husband of ADA ELIZABETH who died 22 September 1941 aged 48 years. [1229]
- D12 748413 Flight Sergeant R.B. BIRTLES, D.F.M. Pilot R.A.F. 16 December 1941 aged 25 years. [1231]
- D14 James Moore [1232]
- D15 Thomas E Teale, Sarah Ann Teale [1233, 1248]
- D16 Ada Simpson [1238]
- D17 George Bachelor [1239]
- D18 Arthur William Haydon [1342]
- D19 In loving memory of ANGELINA beloved wife of FREDERICK HEWITT who fell asleep 24 September 1942 aged 75 years. Also of FREDERICK husband of the above who died 23 November 1950 aged 79 years. [1243, 1326]
- D20 Peter James Landeryou [1247]
- D21 SAMUEL BUBB died August 16th 1943 aged 79 years, also of his wife EMMA BUBB died April 6 1944 aged 84 years. [1249, 1259]
- D22 Elizabeth Mary Bachelor [1250]
- D23 Arthur Wiggett [1251]
- D24 James Clinton [1253]
- D25 Lucy M Jackson, Henry Jackson [1254, 1287]
- D26 John Meigh [1258]
- D27 Thomas Rabin [1260]
- D28 In loving memory of CLARA GILL who died 22 July 1944 aged 84 years, also of AMOS GILL who died 9 October 1952 aged 85 years. [1261, 1346]
- D29 Rebecca Neale [1262]
- D30 Frederick Priest, Harriet Agnes Priest [1264, 1534]
- D31 In loving memory of FREDERICK MARTIN BUNN died May 19th 1943 aged 10 years. [1269]
- D32 Sarah Ann Ross [1272]
- D33 Shirley Savage, (child) [1274]
- E1 In loving memory of my dear brother WILLIAM JAMES SLY who died November 15th 1954 aged 76 years. [1362]
- E2 Treasured memories of CHARLES EDWARD WOOLOFF who died 27 November 1944 aged 71 years. Also SARAH wife of the above who died 18 November 1952. Faithful Verger, Chorister, Bellringer for nearly 30 years. [1263, 1350]
- E3 In loving memory of ELIZABETH ANN MANDER who was called away January and 1945 aged 58 years, also his sister ELLEN AMELIA MANDER who died May 19th 1967 aged 77 years. [1265, 1505]
- E4 William Powles [1266]
- E5 Henry James Sweetman, Harriet Sweetman [1267, 1310]
- E6 Amos Reeve, M Reeve [1270]
- E7 James Lowe [1275]
- E8 In loving memory of ARTHUR JAMES CHAMBERS died May 30th 1946 aged 57 Years. [1277]
- E9 Annie Viggers [1276]
- E10 Robert Patrick Shellard, Joan Shellard [1279, 1297]
- E11 Thomas Jenkins [1280]
- E12 Elizabeth Plowman [1284]
- E13 In loving memory of JESSIE beloved wife of RALPH ADAMS of Hockley Heath died 24 February 1947 aged 39 years. Also RALPH LLEWELYN ADAMS died 14 May 1971 aged 66 years. [1286, 1545]
- E14 ETHEL LAVINIA WILLSON 1879-1947. WILLIAM EMMANUEL WILLSON 1878-1960. [1288, 1418]
- E15 William A Beecham [1290]
- E16 In loving memory of HORACE FREDERICK ROSS died November 27th 1947 aged 61 years, also his wife GERTRUDE LILIAN died 14 May 1962 aged 75 years. [1294, 1442]

- E17 In loving remembrance of ERNEST JOHN PRIEST passed away 1 December 1947 aged 52 years. Also his wife HILDA MARGARET passed away 29 May' 1967 aged 69 years. [1295, 1506]
- E18 Thomas Ernest Priest [1298]
- E19 Mary Millington [1299]
- E20 William Charles Neale [1300]
- E21 Alice Elizabeth Cashmore [1301]
- E22 In loving memory of ANTHONY HANSON died 24 October 1948 aged 81 years, and his beloved wife MARY ANN died 26th May 1950 aged 81 years. [1302, 1320]
- E23 ELLEN TODD died 21 March 1949 aged 84 years, also FRANCIS HENRY TODD died 16 March 1955 in his 89th year. [1305, 1367]
- E24 Harriet Emily Hill [1306]
- E25 Vase: BERNARD TAYLOR died May 11th 1949 [1307]
- E26 In loving memory of SYDNEY GEORGE HARDIMAN who passed to rest 10 August 1949 aged 57 years. Also his wife ELIZABETH HARDIMAN who died 8 June 1967 aged 79 years. [1309, 1509]
- E27 In loving memory of my dear wife FRANCES ALLISON INGRAM died 25 October 1949 aged 76 years. Also her husband JOHN INGRAM died 11 March 1958 aged 82 years. (Vase to: Dear Auntie Alison) [1313, 1398]
- E28 In loving memory of ADA P. GILBERT of this parish died 6th December 1949 aged 78 years, also of GEORGE GILBERT who died 21 January 1955 aged 85 years. [1314, 1364]
- E29 In loving memory of my dear husband WILLIAM LESTER SMITH who passed away on March 26th 1950 aged 69 years. Also MAY SMITH who passed away on February 8th 1959 aged 65 years. [1317, 1405]
- E30 In loving memory of ROSE WALL died 14 April 1950 aged 70 years, also JAMES WALL died 10 February 1959 aged 81 years. [1318, 1407]
- E31 In loving memory of VIOLET SNOOK 1887-1950 and MARTIN CHARLES SNOOK 1884-1965. [1322, 1477]
- E32 Mary Ann Theobald [1334]
- E33 In loving memory of our adopted son JOHN CHRISTOPHER died 7 August 1951 aged 6 years. DOGGETT. [1335]
- E34 In loving memory of HILDA FRANCES SIMPSON died 31st October 1971 aged 50 years. Grand-daughter of JAMES & MARTHA ARTHUR and her husband JOSEPH SIMPSON died 31 December 1978 aged 58 years. [1336]
- E34 In loving memory of HILDA FRANCES SIMPSON died 31st October 1971 aged 50 years. Grand-daughter of JAMES & MARTHA ARTHUR and her husband JOSEPH SIMPSON died 31 December 1978 aged 58 years.
- E35 In loving memory of ELIZABETH JANE PUDDIFOOT died 29th September 1951 aged 78 years, also of ALFRED husband of the above died 14 March 1960 aged 83 years. [1337, 1419]
- E36 In loving memory of THOMAS WHITFIELD who died 16th April 1958 aged 83 years, also of his wife LILY who died 21 June 1970 aged 88 years, and her stepson ARTHUR DAVID EDWARD HYDE who died 1st June 1967. [1400, 1542, 1508]
- E36 In loving memory of THOMAS WHITFIELD who died 16th April 1958 aged 83 years, also of his wife LILY who died 21 June 1970 aged 88 years, and her stepson ARTHUR DAVID EDWARD HYDE who died 1st June 1967.
- F1 In loving memory of CEDRIC ERNEST SMITH born March 3rd 1902, died January 4th 1951. [1327]
- F2 In loving memory of MARY ELLA JONES wife of late JOSEPH JONES died 5 January 1951 aged 81 years. [1328]
- F3 In loving memory of my dear husband NORMAN GREVES died 24 February 1951 aged 61 years, and his wife IDA died 23 June 1969 aged 77 years. [1331, 1529]
- F4 Annie Linzey [1339]
- F5 Nathaniel Smith [1340]
- F6 Elizabeth Moseley [1341]
- F7 In loving memory of EDWARD VICTOR GOODY 10 September 1893 21 May 1952. ROSE GOODY 13 July 1893 - 16 February 1968. [1343, 1517]
- F8 Sacred to the memory of MABEL beloved and devoted wife of HAROLD EASTMAN and dear mother of MARJORIE entered eternal life 11 August 1952. Also HAROLD ALEXANDER SABINE EASTMAN died 5 December 1970 aged 92 years. [1344, 1543]

- F9 Treasured memories of our dear son FREDERICK TURNER died 12 September 1952 aged 36 years. [1345]
- F10 Alice Shellard [1365]
- F11 Florence Matilda Lowe [1347]
- F12 Herbert Wallington [1349]
- F13 Thomas E Beardsmore [1351]
- F14 Treasured memories of LUCY MARY HIRONS died 26 November 1952 aged 70 years and of her husband LOUIS HIRONS died 26 November 1966 aged 84 years. [1352, 1498]
- F15 Ann Maria Parkes, Samuel Parkes [1353, 1354]
- F16 Amy Bertha Hewitt [1356]
- F17 Frederick Thomas Insley [1357]
- F18 George Hawkes [1360]
- F19 Reginald Barrett Goldsworthy Andrew [1361]
- F20 Margaret Patricia Bassett, (child) [1363]
- F21 Ethel Sarah Jenkins [1369]
- F22 In loving memory of our parents LOUISA ELIZABETH SRAWLEY died April 25th 1955 aged 82 years, and JAMES ROBERT SRAWLEY died February 14th 1964 aged 65 years. [1370, 1459]
- F23 In loving memory of FRANK GLOVER died 3 June 1967 aged 68 years. [1374]
- F24 Treasured memories of our dear mother FLORENCE JANE PRICE of Kingswood who died 7 February 1956 aged 80 years. [1379]
- F25 Clara Wiggett [1382]
- F26 Mary Jane Barlow, Sidney Barlow [1384]
- F27 Richard Edwards, Doll Edwards [1385]
- F28 In remembrance of FRANCIS FLOWER 8 April 1957 aged 78 years. Also his wife IDA CAROLINE 5 March 1966 aged 78 years. [1387, 1489]
- F29 Mary Jane Meakin, + Mrs AE ? (ashes?) [1388]
- F30 Treasured memories of our dear mother ANN HURLEY who fell asleep 7 August 1957 in her 100th year. Also of her son WILLIAM HURLEY who died 15 September 1974 aged 90 years. [1389, 1571]
- F31 Dora Westwood [1390]
- F32 In remembrance of JOHN BRADLEY died 23 October 1957 aged 74 years. [1391]
- F33 In loving memory of LOUISA TREYER CHATTERLEY who died 26 December 1957 aged 96 years. [1393]
- F34 In loving memory of CLEMENT WEETMAN who died 30th January 1958 aged 83 years, and his wife DAISY HANNAH WEETMAN died 13 July 1959 aged 88 years. [1394, 1410]
- F35 William Walker [1403]
- G1 ARTHUR JOHNSON a loving husband and father died March 14th 1955 age 67 years. Also ANN loving wife and mother died November 21st 1967 age 79 years. [1366, 1401]
- G2 Loving memory of ARTHUR JAMES MORRIS loving husband and father died April 5th 1955 age 67 years. Also his wife ALICE EMILY loving mother died March 27th 1958 age 70 years. [1368, 1399]
- G3 Edward Sayce [1373]
- G4 Loving memory of ARTHUR GEORGE LINZEY 1906-1955. [1376]
- G5 Loving memory of HELEN (?Henry) MORRIS died September 25th 1956 age ?? also EDITH ??? April 26th 1966 age 68 years. [1381, 1490]
- G6 James Richard Beasley, Eleanor Beasley [1396, 1507]
- G7 Henry Paul Plowman [1397]
- G8 Charles Baldwin [1402]
- G9 Loving memory of GEORGE HENRY BARTON died March 19th 1959 age 67 years. Also his beloved wife FLORENCE BESSIE died November 9th 1965 age 73 years. [1408, 1486]
- G10 Sarah Buttwell [1411]
- G11 Margaret Lucy Wakefield, ?? [1414]
- G12 James Tillyer, Edith Mary Tillyer [1415]
- G13 Loving memory of HORACE BERNARD WALLIS died January 2nd 1960 age 81 years. Also KATE ELIZABETH WALLIS died July 31st 1972 age 88 years. [1416, 1554]
- G14 Loving memory of WILLIAM HENRY WHITEHEAD (BILL) died February 1st 1960 age 71 years. Vase from: BILL & WIN. [1417]

- G15 Peter, Florence Boucker, Leonard Charles Boucker [1422, N68]
- G16 Loving memory of JOSIAH FORTY died result of an accident October 29th 1960 age 50 years. [1423]
- G17 Bertram Turner [1424]
- G18 Ada Emily Heritage, Eli Heritage [1427]
- G19 Ed Percy Taylor, Rose Ann Taylor [1429]
- G20 Ruth Hall, Beardsmore? [1432]
- G21 JAMES FRANK BEASLEY died November 9th 1961 age 50 years. [1434]
- G22 Loving memory of EDWARD JOHNSON born January 11th 1878 died January 10th 1962, also his wife EMMA born December 5th 1889 died March 9th 1963. [1436, 1452]
- G23 Loving memory of my dear husband ROBERT ALAN HARDIMAN died January 22nd 1952 age 41 years. [1437]
- G24 Fond memories of EVELINE VIOLET WALLIS died 13.3.1962 age 82 years. [1439]
- G25 Loving memory of WALTER KEAN died March 15th 1952 age 72 years. [1440]
- G26 Loving memory of MARY GREGORY 1874-1964, also JAMES HINSON GREGORY 1873-1962 [1443, 1460]
- G27 William Hopes, Lucy Mary Hopes [1449]
- G28 Amy Esther Palmer [1450]
- G29 Loving memory of FRANCIS BETTERTON RADBOURN died February 26th 1963 age 77 years. Also EDITH MAY RADBOURN died June 12th 1964 age 85 years. [1451, 1466]
- G30 Robert Turner [1453]
- G31 Simon Charles Webb, Alfred Charles Webb [1455]
- G32 Robert Bernard Jarrett, Pauline + Dorothy Jarrett [1464]
- G33 Maurice Clutterbuck [1447]
- G34 Harry Roden? [1421]
- H1 Loving memory of HARRIETT DAISY WHITE died March 13th 1964 age 76 years. Also her loving husband HUBERT CLARENCE (CHAD) died April 8th 1968 age 71 years. [1461]
- H2 Loving memory of FREDERICK HAROLD WHITE died February 3rd 1973 age 79 years. (crumbling stone - could be further inscriptions) [1462]
- H3 Ida May Gill, E Gill [1471]
- H4 Susannah Courtnall [1472]
- H5 Loving memory of ADA DORIS WAREING died October 29th 1964 age 64. Also her husband CHARLES HENRY WAREING died June 28th 1980 age 82 years. [1473]
- H6 Loving memory of GEORGE GILBERT died November 2nd 1964 age 65 years. [1474]
- H7 Loving memory of FRANK BENJAMIN PITTAWAY died November 22nd 1964 age 68 years. [1475]
- H8 Loving memory of JOYCE ELIZABETH WASTELL died December 14th 1964 age 51 years. [1476]
- H9 WILFRED FREDERICK HOPCRAFT born 14th May 1898 died February 21st 1965. [1479]
- H10 Vase only: ELIZABETH TURTON died September 8th 1965. [1483]
- H11 Benjamin Hiron, Mary Hiron [1484]
- H12 Emily Elizabeth Hawker [1487]
- H13 Loving memory of ALBERT ERNEST SMITH died May 16th 1966 age 87 years. [1492]
- H14 Loving memory of MARY ANN TURNER died November 30th 1965 age 91 years, also her husband and loving father FREDERICK died February 29th 1968 age 95 years. [1488, 1518]
- H15 Frances May Phillips [1489]
- H16 Loving memory of ANNIE PENELOPE FREEMAN loving wife and mother died June 19th 1966 age 79 years. Also her loving husband WALTER FREEMAN died January 12th 1970 age 86 years. Also ROBERT FREEMAN died September 11th 1974 age 66 years. [1493, 1537]
- H17 Loving memory of SYDNEY JOHN TURTON died August 27th 1966 age 82 years. Also his loving wife ELSIE died August 11th 1975 age 86 years. [1494, 1587]
- H18 Loving memory of CHRISTOPHER COLIN SAVAGE died October 27th 1966 age 18 years. [1496]
- H19 Loving memory of RAYMOND ARTHUR COLEMAN born April 13th 1907 died January 14th 1967. A loving husband and father. [1499]
- H20 Arthur John Viggers [1501]
- H21 Sacred to the memory of a dear husband and father HARRY LEONARD CALVERT died April 5th 1967. [1502]

- H22 Keith Alan Smith [1504]
- H23 Vase: To dear ROSA [Warner] 1890-1967. [1511]
- H24 FREDERICK DOUGLAS MUMFORD died November 12th 1957 age 57 years. [1512]
- H25 Ernest Lane, Mary Lane [1514]
- H26 THOMAS LANE 1879-1968. Also JAMES LANE 1885-1969 [1519, 1522]
- H27 Loving memory of ALICE ORTON died October 20th 1968 age 81. Also treasured memories of my dear aunt EDITH HANNAH ETHERIDGE died October 31st 1977 age 82 years. [1520, 1597]
- H27 Loving memory of ALICE ORTON died October 20th 1968 age 81. Also treasured memories of my dear aunt EDITH HANNAH ETHERIDGE died October 31st 1977 age 82 years.
- H28 JOHN WILMETT born May 1st 1883 died December 30th 1968. Also JOHN (?) born 3rd March 1885 died May 5th 1973. [1521, 1561]
- H29 Loving memory of my dear husband JAMES WHITE died March 28th 1969 age 69 years. [1523]
- H30 Loving memory my beloved husband WILLIAM JAMES PRIEST died April 15th 1959 age 69 years. [1525]
- H31 Loving memory of NICOLA ANN HARPER died June 17th 1972 age 8 years. [1553]
- H32 Loving memory of ALICE ROWNEY died March 29th 1969 age 81 years. Also loving husband JOSEPH died February 25th 1982 age 93 years. [1524]
- H33 GLADYS SMITH May 1966. Also GEM SAMUEL SMITH November 1966. [1491, 1497]
- H34 Loving memory of JAMES GARRARD DORMER, Lieut. Col. Indian Army born December 19th 1884 died September 6th 1965. [1482]
- I1 Loving memory of HENRY NORTON SKERRETT born January 5th 1886 died May 9th 1969 also his wife ETHEL AGNES born October 12th 1892 died January 26th 1978. [1527, 1599]
- I2 LOLA ETHEL MARY SCOTLAND. (no dates) [1528]
- I3 Loving memory of LUKE PICKERING loving husband and father born July 18th 1883 died July 14th 1969. Also MATILDA PICKERING beloved wife and mother born July 1st 1894 died November 16th 1975. [1532, 1579]
- I4 CHARITY ANNETTS 1895-1969 also FREDERICK ANNETTS 1895-1977. Reunited. [1533, 1591]
- I5 John Hewitt, Alice Hewitt [1535]
- I6 Edgar Berridge [1536]
- I7 John Turnbull [1538]
- I8 Wm George Satchwell [1539]
- I9 Wilf Insley, Ethel Insley [1540]
- I10 Thomas Docker [1544]
- I11 William Edward Sly, Emily Sly [1549]
- I12 Glenys J Davies, Mervyn Davies [1550]
- I13 Geoff Haycock, Rose Haycock [1551, N81]
- I14 Charles Frederick Linzey, Ellen Emma Linzey [1552]
- I15 GEORGE EDWARD BLYTH born 18th June 1916 died 10th November 1972 also his beloved wife OLIVE PRIMROSE born 19th April 1915 died 12th June 1983. [1557]
- I16 Loving memory of my dear wife JEAN VIOLET GOODE died December 3rd 1972 age 32 years. Dennis Walter GOODE 25th Jan 1939 - 4th July 2021 [1558, N277]
- I17 Loving memory of GEORGE ARTHUR DIPPLE died December 20th 1973 age 62 years. [1559]
- I18 Loving memory of RAYMOND THOMAS NEALE accidentally killed June 29th 1973. [1563]
- I19 Loving memory of EMILY MAY RABIN died August 27th 1973 age 80 years. [1565]
- I20 Loving memory of JOHN LANGFORD CORNAH born 19th January 1924 died 5th July 1982 also our beloved son JONATHAN GRAHAM born 21st December 1948 died 13th February 1974. [1568]
- I21 Dorothy Gardner [1569]
- I22 Loving memory of a loving husband and father PERCY ARTHUR MOULDEN died November 9th 1974 age 60 years. [1571]
- I23 Loving memory of HARRY GEORGE DIGWOOD born July 1st 1884 died November 20th 1974? [1572]
- I24 Elsie Hadley [1575]
- I25 Loving memory of MARY JANE WHITEHEAD died tragically December 15th 1975 age 74 years, also her beloved husband EDGAR THOMAS WHITEHEAD died May 15th 1975 age 74 years. [1585]
- I26 WINIFRED MANTON died February 22nd 1976 age 73 years. [1582]

- J27 Loving memory of ALBERT BEAUCHAMP died March 12th 1976 age 61 years. [1584]
- J28 Loving memory of LESLIE WILLIAMS a loving husband and father died August 2nd 1976 age 60 years. [1587]
- J29 Sydney A Tarplee, Hannah Mary Tarplee [1592]
- J30 HERBERT WALKER died July 6th 1977 age 68 years. Also his loving wife LUCY MARY died October 30th 1978 age 59 years. [1595]
- J31 Loving memory of MAUD MARY BARLOW born December 29th 1915 died September 17th 1977. Until we meet again, JACK. [1596]
- J32 Loving memory of JESSIE MARY JACKSON born 2.11.1893 died 4.12.1977. Also ALGERNON PERCY JACKSON born 5.5.1897 died 26.9.1980. [1598]
- J33 Loving memory of ELIZABETH CHAPMAN "BETTY" devoted wife and mother died March 5th 1978 age 48 years. [N1]
- J18 PETER JOHN BROWN 'Pete' 7.6.34 - 2.11.14 [N258]
- J19 In memory of GERRY REGAN beloved Husband, Dad and Grandad. 24th april 1947 - 7th December 2013 Age 66. Loved, missed and very dear [N253]
- J20 In memory of a brave man. Respected. Loved. CHARLES LAWRIE 17.2.28 - 7.7.84 [N53]
- J21 In loving memory of LOU WILLIAMS (Frederick Louis) 6th Oct 1906 - 6th June 1984 Blacksmith and Farrier. ERIC LOUIS WILLIAMS died 19th Nov 1932 age 1 month. ROSE WILLIAMS 23rd Sept 1909 - 19th Feb 1991 Country Womand and Gardener [N52, N103, N298]
- J22 Joseph Leonard Priest [N50]
- J23 In loving memory of my dear husband FRANK TABOR died 2nd June 1983. RIP. Also his beloved wife FLORENCE died 11th May 1984 Reunited [N44, N51]
- J24 Loving memory of a dear wife and mother JOAN MARGERIE SCHOFIELD died Ash Wednesday February 24th 1982 age 50 years. [N30]
- J25 Edith Holding, Herbert Holding [N27, N59]
- J26 Lillian Whitehouse, Alfred Henry Whitehouse [N26, N57]
- J27 Loving memory of SARAH NEALE loving wife and mother died July 2nd 1981 (no age) [N23]
- J28 PRISCILLA ANN HAYDON died March 7th 1981 age 87 years. [N21]
- J29 Lucy Lancaster, George Lancaster [N19, N47]
- J30 George Robert Alderson [N15]
- J31 Loving memory of HARRY GREEN died January 5th 1980 age 86 years. Also MARIE GREEN died January 31st 1980 age 82 years. To our loving parents. [N11, N12]
- J32 ENID ADIE born July 10th 1903 died June 29th 1978. [N4]
- J33 Loving memory of FREDERICK JACKSON CALDWELL born October 10th 1904 died April 25th 1978. [N2]
- Mem1 In Memory of JOHN HILL Bayliff of Rowington died 1502 A worthy man to be had in memory A good benefactor to Church and poor
- Mem2 Sacred to the Memory of JOHN BRADBURY, GENT. of this parish, who departed, this life September 1". 1835, In the 83rd year of his age.
- Mem3 Sacred to the memory of THOMAS WALLIS ESQ'. Late of Rowington Who departed this life 2nd March 1854 Aged 89 Years This tablet was erected by the sons and daughters of AN() BALL sister of the above.
- Mem4 SACRED to the memory of RICHARD REEVE ESQ: Late of Beaudesert who died June 16° 1811 Aged 65 Years
- Mem5 Near this place Lieth interr'd the body of RICHARD REEVE Gentleman A native of this Parish & citizen of LONDON His free & generous Benefaction To this church Will transmit to Posterity a Lasting Monument of his memory He departed this life the sixth day of FEBRUARY 1765 In the 87. year of his age.
- Mem6 M. S. IOSEPHI STONHALL Nuper Vicarij Hujus Ecclesiæ Qui Obiit Tricefimo die Decembris An: Dom: 1726 Æ tatis 36 Corpus Humo perit, En mirum periendo vigebit Quod cælo vigeat, sæje memento, Perit: N
- Mem8 Giving thanks to God, for the honoured memory of PETER BELLINGER BRODIE M.A.K.G.S. for 45 years Vicar of this parish, and of ISABELLA OCTAVIA his wife, their friends, parishioners and family have dedicated this window AD. 1899
- Mem9 Giving thanks to God, for the honoured memory of PETER BELLINGER BRODIE M.A.K.G.S. for 45 years Vicar of this parish, and of ISABELLA OCTAVIA his wife, their friends, parishioners and family have dedicated this window AD. 1899
- Mem10 IN MEMORY of SAMUEL ASTON of Bushwood Lodge who died 23rd August 1871 aged 74 years. Also

EMMA , Wife of the above who died 29th July 1863, aged 60 years. "Our Trust is in the Lord, for with him is plenteous Redemption." MARIA ASTON who died 19th February 1865, aged 80 years. "Mary hath chosen that good part, which shall not be taken away from her." Also HARRIETTE ASTON who died 27th February 1873, aged 79 years. "I know that my Redeemer Liveth."

- Mem11 To the Glory of God and in memory of MARY THOMPSON, AD 1874.
- Mem12 SACRED To the Memory of SAMUEL ASTON Esquire. (late of Rowington Hall) who died the 20th of December 1820. Aged 66 Years: A Gentleman of inflexible Integrity In whom were united, in an eminent decree. the qualities of a faithful and affectionate Husband and Father. And a warm and sincere Friend ALSO TO THE MEMORY OF JANE ASTON RELICT OF THE ABOVE NAMED SAMUEL ASTON, WHO LIVED UNIVERSALLY BELOVED AND RESPECTED, AND DIED GENERALLY LAMENTED THE 7th DAY OF DECEMBER. 1825. AGED 63 YEARS.
- Mem13 BEHOLD THE MEMORIE OF IOHN WOLLASTON OF RISELIPPE IN THE COUNTY OF MIDDLESEX ESOVIRE DECEASED; WHO MARRIED ANNE SHELLEY, DAVGHTER OF IOHN SHELLEY OF PATCHAM IN THE COUNTYE OF SVSSEX ESOVIRE, BY WHOM HE HAD ISSVE SEAVEN DAVGHTERS THE ELDEST OF WHICH, THOMAS BETHAM OF ROWINGTON IN THE COVNTY OF WARWICKE ESOVYRE TOOKE TO WIFE. CONDITVR HOC TVMVLO WOLLASTON, SPLENDIDA VIRTVS CVI CVRE ET CORDI CVM PIETATE FVIT CORPVS HVMO TEGITER, SVB SAXO HQC OSSA QUIES CVNT EXPECTANT VITÆ SPEM REDI TVMQ PIÆ. SPIRITVS ETHEREAS TENET ARCES, INCOLA CELI EST CALICOLASO INTER NVMINA SVMMA COLIT. Anno Dom-1615
- Mem14 AD 1612 HEARE. LIETH THE BODIE OF THOMAS REEVE, WHICH DEPAR TED THIS LIFE THE FOVRTEINTH OF MAY: AND LEFTE OF HIS ISSVE TWO: JOHN, AND MARIE
- Mem15 To the Memory of WILLIAM SOUTHERN who was vicar of this Church 35 years & died Sept. 30th Anno (DOM 1720 (Æ. tat 69 The Memory of the Just is blessed prov.10.7. And also BARBARA Relict of ye said Mr WILLIAM SOUTHERN, who departed this life (DOM 1722 May 18th An (Ætat 87
- Mem16 Here lieth JOHN OLDNALL and Isbell his wife late bayliff of Rowinton a worthy man to behold in memory who dyed the ? day of August in the yeare of our Lord God MDLVIII being of the age of Three score and xvi yere upon ey
- Mem17 The body of Mrs ELIZABETH REEVE Wife of Mr BENJAMIN REEVE by whom she had issue 4 Sons & 4 Daughters Viz NATHANIELL BENJAMINE RICHARD JOHN SARAH ELIZABETH MARY MABEL She Departed this life December 15 1722 In the 81st Year of her Age. Courteous to all a Wife most kind And left a Mournfull Widdower behind They 59 Years Enjoyd Each others Love And hope through Christ to Reigne with him Above
- Mem18 SACRED to the Memory of ELIZABETH, Wife of the Rev. GEORGE WEALE late Vicar of Rowington, Died 5th of Feb'y 1824 AGED 69 YEARS
- Mem19 SACRED to the Memory of the Rev. GEORGE WEALE late Vicar of Rowington and Native of Warwick Died 22nd of March 1812 AGED 61 YEARS
- Mem20 Here lies the body of SAMUEL SMALBROKE of Rowington the County of Warwick Gentleman who departed this life May 21st 1701
- Mem21 Here lies the body of ELIZABETH SMALBROKE the Relict of SAMUEL SMALBROKE late of Rowington in the County of Warwick Gentleman who departed this life May 5th 1722
- Mem22 IN a Vault Beneath this stone are deposited the Remains of JOHN W (ALL) GENT who departed this Life January 5th 1803 Also of ANN Wife of JOHN WALL who departed this Life January 9th 1828 AGED 85 YEARS
- Mem23 Here lieth the Body of Mrs FRANCES REEVE, Wife of Mr JOHN REEVE, Second Daugh'tr of the Revd Mr RICHARD FARMER Rector of Afhon he departed this life the third day of September Ano 1723. AElatis 45
- Mem24 To the Glory of God and in loving memory of ISABELLA OCTAVIA BRODIE Faithful worker in the girls friendly society for 21 years. This window is placed by her friends in the Warwick branch of the G.F.S. A.D. 1896
- T25 John Pullen [N300]
 U5 Stuart Weir [N289]
 U6 Alan Gould [N279]
 U7 George Henry King, Margaret Evelyn King [N271, N274]
 U8 Theodore Christophers [N268]
 U9 John Priest [N261]
 U10 Frank Priest [N259]

U11 Franco Carlo Vegnuti, Barbara Vegnuti [N255, N302]
 U12 Reg Johnson, Ethelle Johnson []
 U13 Felix Sheridan, Catherine Valerie Sheriden [N252, N293]
 U14 Paul Jackson, Edna Jackson [N248, N267]
 U15 Freda Dance [N243]
 U17 Tenbeigh Hobday [N241]
 U18 Roy Ingram Lowe [N238]
 U19 John Hibbs [N237]
 U20 George Morris, Jenny Mary Bilsden Morris [N236, N290]
 U21 Susan Phillips [N231]
 U22 Betty Margaret Whitehead, Leslie Whitehead [N227, N228]
 U23 Patricia Bevins, Clive Bevins [N222, N246]
 U24 Elizabeth Styles [N221]
 U25 Kenneth Brownhill [N219]
 U26 Amos George Reeve [N218]
 V5 Jean Pitts, Michael Pitts [N122]
 V6 Frederick R Bowcott, Ivy Eileen Bowcott [N135, N223]
 V7 Richard Charles Hitches [N138]
 V8 Jessica Fitzpatrick [N139]
 V9 Nigel Insley, Shirley Ann Insley [N141]
 V10 June Dawn Taylor, Robert Taylor [N145]
 V11 Meryl K Neal, James Neal [N152]
 V12 Molly Blizzard, William George Blizzard [N156, N203]
 V13 Ernest Heritage [N157]
 V14 Winifred Mary Green [N159]
 V15 Evelyn Joan Dodd [N166]
 V16 Gwyneth Penrice [N170]
 V17 Catherine Mary Hitches [N172]
 V18 Brenda McCloskey [N182]
 V19 Iris Nora Lee [N190]
 V20 Dennis Cauldwell [N196]
 V21 John Barry Wild [N197]
 V22 Peter Charles Adams [N198]
 V23 Ted Taylor [N204]
 V24 Joseph Dee [N207]
 V25 John Rickett [N209]
 V26 John Joseph Davies, Valerie Davies [N211, N225]
 W1 John Brian Simmons, Sylvia Simmons [N54, N285]
 W2 Hilda Agnes Chapman, Alice Chapman [N56]
 W3 William Sayce, Margery Sayce [N60, N292]
 W4 Peter Smith, Betty Smith [N67, N178]
 W5 Mary Graham [N69]
 W6 Alan Arthur Westwood, Alice Hilda Westwood [N71, N72]
 W7 Lucy Hitches, Edward Hitches [N73, N96]
 W8 George Beckett [N75]
 W9 Dora Smith [N76]
 W10 Andrew Weir [N79]
 W11 Gerald Holmes, Monica Holmes [N80, N213]
 W12 Roland George Bailey, Freda Mary Bailey [N85, N202]
 W13 Amy Powell [N90]
 W14 Ronald John Taylor, Anne Elizabeth Ives Taylor, [N95, N47]

W15 Emma Sly, Bridie Sly [N97, N256]
 W16 Bertram John Wimlett, Leslie Roy Wimlett [N100, N128]
 W17 Georgia Morton-King [N101]
 W18 Ellen Elizabeth Clarke [N104]
 W19 Trevor Davies, Patricia Davies [N108, N264]
 W20 Harold Brown [N111]
 W21 Leonard Taylor [N112]
 W22 Emma Selina Attwood [N113]
 W23 Henrietta E Oakley, S Oakley [N114]
 W24 John Cambray [N116]
 W25 John R Page [N120]
 W26 Sydney Freeman [N123]
 W27 Iris Beatrice Fox [N130]
 W28 Harold Lawrence Rudge [N131]
 W29 Alfred Chris Pickering [N192]
 WM1 T.A. VARDY 2nd Lieut. 4 R.W.R. July 1916 killed in France.
 WM2 W.H. WRIGHT R.M.L.I. Sunk in H.M.S. Pathfinder September 1914
 WM3 GEORGE HOPCRAFT Cpl. 2nd L.R. May 1 1915 Killed in France.
 WM4 P. WILLIAMS Sgt. R.F.A. July 21 1917 died in Mesopotamia.
 WM5 T.R. SMITH Sgt. Maj. K.R.R. January 26 1916 Killed in France.
 WM6 T.W. WILLIAMS Gunner R.F.A. January 14 1916 Killed in France.
 WM7 D.T. SMITH Trooper W.I. Yeo. April 23 1916 Killed in Egypt.
 WM8 C.H. MALIN Pte. Can. I. 5th July 1916. Killed in France.
 WM9 W. MALINS Shoeing Smith W.I. Yeo. August 7 1916. Killed in France.
 WM10 G. ROWNEY Sgt.Maj. K.R.R. August 24th 1916. Killed in France.
 WM11 A.V. EDWARDS Lance Cpl. Lon.Reg. September 15 1916.Killed France
 WM12 H.H. WOOLLOFF Pte. R.W.R. March 1 1917. Killed France.
 WM13 A. SLY Pte. 16th Battn. A.I.F. April 14 1917 died Australia.
 WM14 A. JOHNSON pte 17 Worcs. April 25 1917 killed Greece.
 WM15 C. MALIN Cpl. Can. May 8 1917 Killed France.
 WM16 C. DIPPLE Gunner R.G.A. May 28 1917 killed France.
 WM17 G.J.NEALE Pte.Coldstream Gds. June 19 1917 killed France.
 WM18 C.J. TEALE Dr. M.T. June 2 1917 died in India.
 WM19 M.H. ORCUTT 2nd Lieut. March 1 1918 killed France.
 WM20 I. MERRIMAN Pte. R.W.R. August 14 1917 killed France.
 WM21 G.H.PRIEST Lc.Cpl. Ox. & Bucks L.I. December 3 1917 killed France.
 WM22 E.G.MOORE Pte.Lab.Corps November 23 1918 died England.
 WM23 E.W. GHENT A.V.C. February 14 1919 died England.
 WM24 JOHN TYRELL AUSTIN Sgt. R.A.S.C. February 1 1940 died England.
 WM25 RONALD BOSWELL BIRTLES D.F.M. Ft/Sgt.R.A.F. killed in action December 16 1941.
 WM26 CLAUDE ROBERT DURRANT Pte. R.A. May 2nd 1940 killed at Dunkirk.

Orphaned Inscriptions

The following inscriptions were noted in the 1980 survey, but the grave to which they relate can no longer be located. The probable location is noted.

Inscription

In loving memory of SUSAN GARDNER died December 14th 1927 aged 75 years. Also her husband GEORGE GARDNER died June 5th 1929 aged 65 years.

CECIL HENRY EVANS 19 July 1979 aged 80 years.

In loving memory of MARY GLADYS JENKINS died 2 June 1974 aged 66 years, reunited with her beloved husband CHARLES ALBERT died 25 September 1982 aged 78 years.

In loving memory of HOWARD WONTNER-SMITH 16 June 1878 11 November 1963 and LILIAN LORD WONTNER-SMITH 12 October 1883-4 October 1968.

In loving memory of DOROTHY SHAW died 25 August 1961 aged 78 years.

In loving memory of RICHARD HARRIS who died August 2nd 1937 aged 51 years, also of his wife ELIZABETH who died October 1st 1938 aged 55 years.

Sundial - In memory of OSYTH MARY GILLIAN the dearly beloved wife of Lieut. Col. DOUGLAS N. STEWART, D.S.O., M.C., The Royal Scots Greys who died 28 September 1950 aged 34 years, and their infant son RORY a ooooo weeks.

In loving memory of KATHLEEN daughter of VIOLET & ALLAN BOYLES died June 21 1927.

In memory of ERNEST WILLIAM GHENT died February 14th 1919 aged 38 years.

FANNY wife of ARTHUR E. SMITH of Quarry Farm died August 1st 1905 age 74 years.

STEPHEN SMITH born 4th December, died 13 December 1899. In memory of ELIZABETH ANNE BULMER oooo (broken stone may be others)

LILLIAN TURNER 1915-1981.

JEAN MERRY died January 22nd 1871. (no age given)

ERNEST WILLIAM GHENT died February 14th 1919 age 38 years.

Loving memory of LUKE HOBSON died January 9th 1968 age 4 months.

Vase: MARGARET PATRICIA BASSETT died January 15th 1955 age 2 years.

GEORGE TAYLOR also his wife ELLEN died October 29th 1915 age 75 years.

Loving memory of JANE CARTWRIGHT died August 27th 1925

Probable Location

Near 161 (Smiths)

Between 201 and 202

With old cremation burials?

With old cremation burials?

With old cremation burials?

After Ostins

Between C1 and E2

Between Francis Mumford and Pvt Moore

Between Isaac lane (239) and Hanson (245)

Between Sly and Edgecox (North border)

Gem, War memorial, Scholefield (164)

Gem, War memorial, Scholefield (164) West boundary?

Same as 236 (Ghent)

With old cremation burials?

Near Emily Grice (AA31)

Yew near loo or Moore (222)

A7 - A17

Index of Surnames from the Burial Registers

Note:

Numbers prefixed with N indicate the entry number from the new Burial Register which began in 1979.

Numbers without a prefix are from the old register from 1859-1978. Scans of the burial registers are available on our website at

RowingtonRecords.com/Church/St Laurence

Rowington/index.html

A

Adams	1010,1063,1286,1545,N198
Adie	N4
Adkins	117,444,610,699,973
Alderson	N15
Allday	1043,1100,1170
Allen	308,362,1088,1131,1207,1311, 1562
Alsop	171
Alton	464
Anderton	237
Andrew	1361
Annetts	1533,1591
Appleby	N283
Arnold	162,196
Arthur	846,1069,1336,1386
Askew	380,567
Aston	63,89,225,256,275,434,546
Attwood	381,388,N113
Austin	1203,1485,1576,1577,N161
Avern	19,74,145,193,550,753,1073,1153, 1168,1228

B

Bachelor	947,1019,1239,1250
Badger	803,1013,1046,1112,1195
Bailey	920,1213,N202,N85
Bainbridge	N118
Baker	684,768,931
Baldwin	1402
Barber	525,577
Barlow	1147,1384,1510,1596
Barnbrook	163,219
Barnes	479
Barnett	8,333,340,592,748,829,869
Barton	1408,1486
Bassett	1363,N193

Batchelor	935
Bates	98,120,169,247,271
Batten	1008
Bayliss	188
Beardsmore	1351,N41,N244,N244
Beasley	690,1391,1396,1434,1470,1507
Beauchamp	1584,N92
Beck	749,N188,N286
Beckett	N75
Beecham	850,943,1121,1223,1290
Beesley	N83
Bembrooke	594
Benbrook	61,224,377,408,512,656
Bennett	1142
Berridge	1536
Berril	215
Berrill	449,676,879,1022,1041,1059
Best	1444
Betts	522,678,1182,1500
Bevington	491
Bevins	N222,N222,N246
Biddle	83,167
Bills	75
Binbrook	12
Birtles	1231
Blackwall	1130
Blackwell	977
Bladon	1114,1181
Blizzard	N156,N203
Blyth	1557,N46
Boddington	160
Bodington	25
Boggust	N133,N151
Bolton	52,84,85,269,270,302,317,325, 358
Boneham	241,466,704
Bonham	77,92,264,499,799
Booth	1467
Boswell	893,896
Boucker	1422,N205,N68
Bourn	689
Bowcott	N135,N223
Boyles	1049,1057,1078
Bradbury	178,367
Bradley	N93,N94
Bragg	34,128,191,211,370,520,556,560,5 85,595,663,714,735,924,1005, 1159,1202

Brain	N110,N194	Coles	152
Branson	353,467,962,1108	Collies	250
Brewer	1319	Collins	246,N115,N189
Brittain	1171,1404	Conradi	1512
Brodie	280,614,650,670	Cook	455,788,1070,N175
Bromilow	1564	Coop	N233
Brookes	21,40	Cooper	78,747,831,834,1126,1209
Brown	456,706,N111,456,706,N111, N258	Corbett	766,940,1061,1428,N214
Brownhill	N219	Cornah	1568,N34,N272
Brownsell	518	Courtnall	733,1472
Bruff	502	Courtneil	64,90,272
Bubb	815,838,1249,1259	Cousins	1054
Buckingham	107	Cowley	493,819
Buckley	373	Cowperthwaite	796
Bulmer	848	Cox	N294
Bunce	489	Crapper	392,540
Bunn	49,146,223,321,336,471,612,638, 726,732,742,806,882,1164,1222, 1268,1269	Cross	46,111,202,374
Burgess	354,405	Currall	1189,1333
Busby	1372	D	
Butterworth	883	Dance	993,993,N243
Butwell	589,1411	Darby	1430
C		Davies	1550,1567,N108,N208,N211,N216, N225,1550,1567,N108,N208,N211, N216,N225,N264
Caldwell	N147,N196,N2	Davis	127,741
Calvert	1502	Dawson	830
Cambray	N116	Dean	1120
Canto	N249	Deathridge	934
Carpenter	785	Dee	N207
Cartwright	608,1038	Digwood	1572,N168
Cashmore	509,605,730,912,997,1301	Dilley	N282
Castle	424,482	Dilly	N154
Chambers	1277,N117,N176	Dimelow	660,675
Chapman	N1,N56,N125,N229,N250,N254, N250,N250,N254	Dipple	1559,N70
Chatterley	1393	Docker	1544,N89
Cheshire	1586	Dodd	N166
Cheshire	N42	Doggett	1335
Christophers	1355,N107,1355,N107,N268	Donnelly	1143
Clark	113,204,286,399,409,606	Dormer	1482
Clark	24	Douler	134
Clarke	17,31,257,414,435,791,795,875, 1220,N104,N301	Draper	44,123,184,451,503,533,581,611, 632,641,745,776,794,825,881,886, 1031,1148,1172
Clewes	176	Drinkwater	625,637
Clews	236,729,801,876,1064	Dugard	314
Clinton	1253,1378	Dumbleton	600,826,1117
Clutterbuck	1447,N78	Dunn	773
Cocks	1585,N119,N66	Dutton	30,53,55,199,281,384,490
Cole	N199	Dyson	1489,1561
Coleman	1499,N191,N39,N288	E	
		Eade	N183

Eastman	1344,1543	Gardener	465
Easton	N165	Gardner	190,263,341,347,386,555,653,665, 862,900,929,986,1066,1084,1458, 1569
Eborall	101,157,158,315,356		
Edge	1060		
Edgecox	771,786,854,918,1051	Gem	151,153,179,182,221,229,327, 542,909
Edkins	156		
Edmonds	N137,N153	Genders	652,737
Edwards	1255,1291,1385,N142,N180,1255, 1291,1385,N142,N180,N245,1255, 1291,1385,N142,N180,N245,N263	Genge	1495
		Gent	118,265,402,639
		Ghent	102,598,761,800,849,949,1134
		Gibbs	28
Eggleton	1101,1132	Gilbert	1314,1364,1474,1569
Elkington	814	Gill	1261,1346,1471,N20
Elliott	765,777,967,1012	Glaze	959
Emms	58,205,447	Glover	1508,N14
England	324,349,352	Goddard	15,133,207,1032,15,133,207, 1032,N251
Etheridge	1597		
Evans	688,739,N10,N167,N234	Gold	601,634,822,1034,1037,1074, 1085,1116
Everitt	1377,1395,N185,N186		
Eveson	1560	Goode	1558,N277
Ewins	958	Goody	1343,1517
Eykyn	1521	Gordman	694,695
F		Gould	131,214,359,569,N279
Fairfax	159,175,779,1080	Graham	N69
Fardon	1208,1218,1282,1438,N158,N270	Graves	173
		Green	242,243,283,573,574,575,740,774, 783,1018,1136,1210,1221,N11, N12,N159
Farmer	707		
Faulks	66	Gregory	1443,1460
Featherston	278	Greves	166,262,1331,1529
Featherstone	545	Grice	1047
Fell	622,N126,N179	Griffin	22
Fetherston	235	Grove	618
Fetherstone	3	Groves	60,368,445
Field	369	Grumbley	892
Finden	95,183	Gubbins	76
Fisher	N297	Gumbley	376,411
Fitzpatrick	N139	Gurden	1199
Fletcher	624,873,981	H	
Florence	13,14	Hadland	604,734
Floriday	1076	Hadley	1575
Flower	1387,1489	Hale	312,N232
Foden	1446	Hall	1432
Forty	1423,N64	Hancock	870,877,1091,1545,N63
Fox	N130	Hancox	348,682
Francis	674,685,863,1215,N82	Handley	216,418,441
Franklin	636	Hands	147,222,339,436,443,452,462,571, 644,725,755,759,782,983,1025
Freeman	1493,1537,1571,N123	Hanson	59,149,259,346,672,719,1023, 1302,1320
French	342		
Fulford	42	Harbon	1190,1273
G			
Gallimore	655,686,1089,1321		

Harborne	505,510	Humphries	723
Hardiman	1309,1437,1509,N215	Hunt	360
Harding	332,778	Hurley	494,1389,1571
Harmer	572,923	Hutchinson	593,969,1150,1383
Harper	769,1553,N35,N62	Hyde	1508
Harris	944,1040,1107,1157,1176,1188	I	
Harrison	7,1596,1596		
Harwood	299		
Hastings	4,519,602	Ingram	458,586,649,691,780,787,827,842, 922,1009,1036,1039,1206,1313, 1398
Hathaway	112,253,337,526,731		
Hatton	1561,N132	Insley	1110,1180,1357,1540,N121,N141, N226
Hawker	1487	Ives	1044,1235
Hawkes	144,251,335,1360	J	
Hawkins	73,995		
Haycock	1551,N81		
Haydon	1242,N21		
Hayward	273		
Heath	56,284,1095,1135	Jackson	1254,1287,1571,1598,N18,1254, 1287,1571,1598,N18,N248,1254, 1287,1571,1598,N18,N248,N267
Hedge	47,154		
Hemming	642,968	James	936
Herbert	226,486,840	Jameson	563
Heritage	933,1427,1456,N157	Jarrett	1464,N171
Hewitson	1565	Jarvis	N224
Hewitt	234,296,529,797,837,1187,1243, 1326,1356,1535,1555	Jenkins	932,1280,1369,1569,N37
Hibberd	463,860	Jennings	32,70,129,135,426,802,955
Hibbs	N237	Johnson	230,428,558,631,852,884,904,1026 ,1316,1366,1401,1436,1452,1513, N136,230,428,558,631,852,884,904 ,1026,1316,1366,1401,1436,1452, 1513,N136,N239,230,428,558,631, 852,884,904,1026,1316,1366,1401, 1436,1452,1513,N136,N239,N240, N276,N284
Hickin	1083		
Hides	972	Jones	1328
Hill	1306,N187	Jordan	231,683,692
Hinson	33,35,187,294,351,477,552,693, 762,938	Joyce	228
Hirons	1352,1484,1498,N61	Joyner	957
Hitch	79	K	
Hitchcox	172		
Hitches	N138,N172,N73,N96	Kean	1440
Hobday	N241	Keen	498
Holding	N27,N59	Kelland	N235,N299
Hollick	1205,1406	Keller	1030
Holmes	N213,N80	Kember	963
Holtom	548,570,880,927,960,1062	Kettle	1020,1141,1240,1595
Hopcraft	1105,1246,1425,1479,1503,N184	King	412,798,864,987,N271,N274
Hopcroft	671	Kirby	1158,1256
Hopes	1449	Knight	2
Hopkins	26,181,396,597	Kuntur	N200
Hopson	1516	Kyte	N217,N220
Hornsey	950		
Horseman	859		
Houghton	1156,1156,N265		
Howard	488,667,956		
Hull	710,711,712,713		

L			Merry	20,240,300,394,461,633
Lakin-Smith	1375,1530		Middleton	72,99,103,109,328
Lancaster	311,584,N19,N47		Millington	1299
Landeryou	1247		Mitchell	11,506,659,1075
Lane	39,307,357,460,527,559,646,651, 661,722,770,939,970,994,1098, 1281,1514,1519,1522,N40		Moore	96,97,108,249,255,276,297,371, 459,504,544,580,590,621,821,844, 878,941,951,961,966,1028,1212, 1232
Laughton	1489		Morley	1140,1358
Lawrence	1315		Morris	320,415,681,775,1016,1186,1368,1 381,1399,1490,N236,N290
Lawrie	N53		Morton-King	N101
Lawson	N291		Moseley	38,68,203,227,287,291,363,420, 669,888,889,952,988,1341,1441, 1445
Lee	N190		Moss	847
Leeson	6,393,419		Mould	N24,N49
Leigh	1478		Moulden	1571,N91
Lewis	541,910		Mullis	576
Lickorish	N287		Mumford	1067,1197,1252,1409,1511,N177
Linforth	626,828,1077		N	
Lingard	1014		Neal	197,245,756,N152,N210
Linzey	1079,1086,1122,1339,1376,1552, N32		Neale	708,1033,1045,1163,1262,1300, 1563,N129,N23
Littlejohn	244,304,344		Neville	88
Lowe	1275,1347,N238		Newbery	623,643
Lucock	1413,1520		Newton	1111,1245
Lynas	453		Nicholls	998
M			Nichols	1175
Madeley	979,1332		Noakes	1211,1219
Malin	106,148,233,248,338,413,421,437, 654,871,1448,N87		Norris	91
Malins	16,139,174,1185,1519		O	
Mander	627,744,855,911,913,1230,1265, 1505		Oakley	N114,N144
Mann	1204,1380		Oliver	130,379,395,891,906,980,985
Manton	18,407,1582		Onens	1071,1127
Marles	484		Orcutt	1191,1237,1574
Marriott	69		Orton	1520
Marshall	738		Osborn	104,288,289,290,292,468
Martin	N281		Osborne	615
Mason	252,470,511		Ostins	1463,1589
Masters	23,282,366,680,809		P	
Mawson	1106		Paddock	975,1103,1374,1465
Mayou	439,440		Page	866,1113,1412,N120
McCloskey	N182		Painter	50,387
McLennan	N295,N99		Palmer	5,517,645,673,763,989,1001,1166, 1450,N163,N8
McWilliams	1420,1593		Parker	N149,N16
Meacock	521		Parkes	1353,1354
Meakin	1388		Parsons	93,116,562,926
Meanley	1216		Paterson	818
Meanly	1173		Payne	1183,N88
Meigh	971,1258			
Meredith	587			
Merriman	816,1296,1312,1480,1573			

Peach	189	Reeve	701,914,1029,1214,1270,1547, N218
Peebles	N273	Reeves	355,553
Pendleton	1217	Regan	N253
Pennice	1570	Reynolds	554,793,1304,1348
Penrice	N170	Richardson	1229
Perkins	143,198	Rickett	N209
Perks	165	Robbins	323
Pershouse	105	Roberts	168,N275
Pettitt	254	Robinson	416,789
Petty	N109,N33	Roden	1421,1570
Phillips	1489,1489,N231	Rogers	473,474,485,583,603,640,868,1021 ,1056
Pickering	1196,1510,1532,1568,1579,N192	Rollings	309
Pickett	383	Roper	27,495,516
Pilbeam	1371	Rose	51
Pinfold	306,330,401,422,480,564	Ross	1272,1294,1442
Pittaway	1475,N195	Rowe	N160,N86
Pitts	N122	Rowney	1003,1097,1524,N31
Plant	80,180	Rudge	1042,1435,N131
Plowman	142,476,861,895,978,1284,1397	Ryland	1072,1145,1468,1556
Powell	894,937,984,1092,1541,N90	S	
Powles	1266	Sacchman	1431
Pratt	524	Sanders	87,132,140,268,277,566,1017
Preece	1004	Satchwell	532,536,1539
Prestridge	965	Savage	1274,1496
Price	41,378,391,1379	Sayce	1373,N124,N60,N292
Priest	82,754,760,784,810,925,996,1007, 1011,1048,1123,1124,1125,1128, 1160,1167,1264,1285,1295,1298, 1338,1486,1506,1525,1533,1534, N143,N169,N206,N50,N259,N261, N259,N259,N261	Schofield	N146,N155,N30
		Scholefield	472
		Scotland	1528
		Sear	417
Prior	200	Seddon	N242,N242,N257
Pritchard-Gordon	N173,N9	Shakespeare	65,194,201,845,872,1081
Provitt	267	Sharman	274
Prue	930,1087	Shaw	1433,N105,N106
Puddifoot	1337,1419	Sheasby	186,218
Pullen	N300	Sheehan	N162
R		Shellard	1279,1297,1365
		Shephard	534
Rabin	578,664,764,1027,1177,1260,1565, N29,N77	Sheridan	N293
		Sheriden	N252
Rabone	100	Shirley	29
Radbourne	902,1451,1466	Simmons	N285,N54
Randall	514	Simpson	361,543,549,607,677,817,832,835, 897,1035,1238,1548,N7
Rathbone	728,781	Skerrett	1527,1599
Ray	953	Skinner	1227,1241,1454
Raybould	454	Sly	86,177,285,364,492,538,721,823, 901,946,948,1200,1283,1362,1549, N230,N55,N97,N256,N256
Read	N13,N74		
Reason	382,385		
Redfearn	1545,1570		

Smith	110,124,125,126,136,161,206,210, 212,213,232,238,295,319,343,345, 442,481,530,537,551,609,648,700, 716,717,758,916,917,1093,1104, 1115,1154,1155,1179,1201,1234, 1317,1323,1327,1340,1359,1405, 1491,1492,1497,1504,1578,1581, N150,N174,N178,N45,N67,N76, N269,N269,N278	Tod	767
		Todd	1305,1367,1566
		Tomes	398,406
		Tovey	1137,1184,1194,1224,1308
		Troth	326
		Turley	N28
		Turnbull	1538,1546
		Turner	316,1345,1424,1453,1488,1518, N25,N43,N48
Smitten	751,903	Turton	588,658,974,1052,1483,1494,1578
Snook	1322,1477	U	
Soden	9,1102	Unknown	185,547,1068,547,1068
Spencer	724,899	Upton	114,115,279,507,727,858
Srawley	1370,1459	V	
Stanley	976	Vant	1149
Steel	657,808	Veale	1144
Steele	301	Vegnuti	N255,N302
Stephens	429,1278,1590	Venner	1595
Stewart	1324,1325	Viggars	N127
Street	155	Viggers	138,150,696,856,945,954,999,1225, 1276,1501
Styles	N221		
Sumner	662,824	Vigors	54
Sumners	865	Vyness	478
Sumness	425	W	
Swain	N212	Wainwright	N3
Sweetman	483,528,709,743,811,982,1133, 1139,1161,1267,1303,1310	Waistell	1476
		Wakefield	1414,1426
Swetman	1	Waknell	1119,1138
Swinbourn	613,792	Walden	867,942,991,1165
Swinbourne	164,298	Walker	992,1015,1403,1595,N5
T		Wall	1318,1407
Tabor	N44,N51	Wallington	1349
Tarplee	1592,N22	Wallis	318,496,568,687,1094,1151,1416, 1439,1554
Taylor	10,43,48,81,119,122,260,303,305, 350,375,389,390,397,400,430,438, 446,487,497,501,531,561,565,582, 599,616,617,628,629,635,668,697, 705,750,772,812,820,833,851,857, 908,921,1006,1053,1162,1193, 1292,1293,1307,1429,1469,1515, 1594,N112,N145,N204,N95,N247, N260,N247,N247,N260	Walton	313
Teal	448,523,619,620	Ward	1178,1481
Teale	698,1198,1233,1248,1289	Wardell	209
Theobald	1334	Wareing	1473,N17
Thompson	261	Warmington	423,746
Thorpe	N164	Warner	1511
Tibbits	137,141	Watson	N262,N262,N266
Tibbitts	500,508,647	Webb	513,1169,1455,N6
Till	N201	Webster	630
Tillyer	1415,1531	Weetman	372,427,431,432,715,720,905,1002, 1055,1099,1394,1410
		Weir	N289,N79
		Wells	71
		Weston	217
		Westwood	N71
		Westwood	752,898,1109,1390,N72

Wheeler	322	Willson	1257,1288,1418,1569
Wheetman	220	Wilmin	329
White	36,37,121,192,403,404,433,457, 515,539,557,703,757,807,887,890, 907,915,928,990,1050,1226,1342, 1461,1462,1523,1560	Wilson	469,591,1236,1392,N65
		Wimlett	1521,1561,1578,N100,N102,N128
Whitehead	836,841,964,1192,1244,1417,1580, 1585,N140,N227,N228	Wise	702
Whitehouse	N26,N57	Wodward	1174
Whitfield	1065,1400,1542	Wontner-Smith	1457,1521
Whitmore	67,293,475,679,736	Wood	596,N181
Whyman	1152	Woodall	N296,N36
Wiggett	1090,1251,1382,1588,N38,N98	Woodhall	N84
Wiggins	1129,1330	Woodward	334,365,666,718,839,1024,1082
Wigley	805	Woolloff	1000,1263,1350
Wilcock	N280	Worwood	1096
Wild	N197	Wright	57,195,239,258,410,450,790,804, 843,874,1058,1271
Wilde	579	Y	
Wilkins	1146	Yardley	1329
Williams	62,94,208,266,310,331,535,813, 853,885,919,1118,1482,1519,1526, 1583,1587,N103,N134,N148,N52, N298		

Historical Notes on families

Aston

The Aston family came to Rowington in 1806 from Wroxall. They bought Rowington Hall and acquired the Lay Rectorship of the church with it, which meant that they had to 'keep up' the chancel of the church and also had the right to erect monuments therein.

These first Astons in Rowington were Samuel and Jane (see memorial in church). Samuel and Jane had several children: Samuel jnr, Maria Harriette and Emma (see memorial in church) also John (162) Jane, Sarah, Ann and Helena.

Samuel jnr. lived at Bushwood Lodge.

John was living at Rowington Hall in 1841 with Lucy, his wife and their three children: Lideis aged 4 yrs, Littleton aged 2 yrs and Jane 7 months (131).

Maria, believed to be the eldest daughter of Samuel and Jane, was recorded as Head of the Household at the Hall in the census of 1851. Her sister Harriette lived with her, both sisters being unmarried. They had a resident companion Miss Ann Betts living with them.

Jane, another sister married one John Meredith, widower, in 1814. Laura (162) was their daughter.

Avern

William and Susannah Avern (128).

William is not recorded in Parish Records but Susannah d. 1759, mother of Clement.

Clement Avern (128) was married to Mary and had five children. He is believed to have d.1798.

James and Mary Ann Avern (84). James is believed to be son of the above Clement and to have married one Ann Burdon, also called Mary hence Mary Ann in 1776.

William and Mary Avern. Mary (87) believed to be mother of the above James.

James Avern (89), son of Wm and Mary.

Thomas and Mary Ann Avern (86) were married in 1814 (he being previously married to Anne (90)).

This Thomas lived at the Malt House and was miller at the Tom O' the Wood Mill. Described in 1841 census as 'Maltster'. In 1851 Thomas was 78 yrs and Mary Ann was 61 and their daughters Mary Ann aged 31 and Harriet aged 26 lived at home.

By 1861 Thomas was dead and Mary Ann snr farmed 14 acres with the help of her daughter, also Mary Ann.

Anne (90), first wife of Thomas, nee Newey, was married 1802 and d.1808.

Thomas and Harriett Avern (152). This Thomas is believed to be son of Thomas and his first wife Ann. In 1861 a Thomas Avern was living at Oldfield.

Ball

George Ball (144) is described in census of 1851 as 'Horsedealer', then aged 55 yrs, born at Hatton and then living at Foxbrook Farm, with his daughter Ann Elizabeth aged 29 yrs and three servants. He was not in Rowington in the earlier census of 1841 and there is no record in the parish records of his wife Sarah.

Bolton

In 1841 a Joseph and Martha (28) his second wife farmed in the area.

In 1848 there were four Boltons either owning or occupying land in Rowington.

Joseph Bolton owned Brookhouse Farm, Lowsonford.

A William Bolton owned land at Holywell and lived in Holywell House, also renting a very large acreage in the parish.

Another Bolton owned The Limes in School Lane and another is thought to have lived at Finwood Farm.

Brodie

Peter Bellinger Brodie was for 44 yrs vicar of the parish. He was an enthusiastic Palaeontologist who wrote several books on the subject. (6).

Cookes

William Cookes d.1828 (177), believed to be father of Wmm the Shoemaker of The Cottage who was 55 yrs in 1851.

Gardner

William and Martha Gardener (146) had three children: Wmm jnr, Mary and Maria.

William jnr was a tailor who lived in the cottage near the bridge by what is now The Tom O the Wood public house. This William also repaired the musical instruments used in the parish band which once accompanied church services. (He was paid for repairs to the bassoon .in 1820 and the clarionette in 1821).

Elizabeth Gardener (33) is not thought to have been related to those above but rather to another Gardener family, Samuel and Revecca. Samuel was a Cooper who lived in the village. A daughter Elizabeth was recorded in the census of 1841, then 10 yrs old.

Gazy

The Gazy family first appear in Rowington records in 1755. They were Parish Clerks and Carpenters and Joiners. They gave great service to the parish and the church.

The first Gazy was John who married Ann Cookes in 1755 and had 10 children. John was Parish Clerk and d.1801.

William (50), one of their sons married Mary Ann Avern in 1802. He was also Parish Clerk, acting as his father's assistant then taking over when he died. Wmm was also a carpenter and joiner.

Joseph, younger brother of Wmm was schoolmaster at Rowington d.1810. Another brother, John, d.1813.

Whilst Parish Clerks the Gazy's occupied a cottage in the churchyard, thought to have been a single—roomed cottage to the left of the twenty steps down to the road opposite the South door of the church.

No Gazy's appear in the 1851 census.

Gem

The Gem family owned Moorhills, Sandhills and Rookery having moved to Rowington in or about 1824.

Samuel Edward Gem (40) and his wife Mary Ann married in 1824.

Mary Ann, their daughter, d.1915.

Samuel Edward, their eldest son died 1890.

A second son, William Henry was a miller and ran the Windmill at Rowington Green in 1861.

Caroline Adelaide, their fourth child married Joseph Osborn of Lapworth in 1859. (159).

Richard Gem (39) of the Dragoon Guards is believed to be brother to Samuel Edward snr.

—0—

(159) Joseph Osborn of High Chimneys Lapworth married Ann nee Jenkins. This Joseph d.1866 and Ann d.1837.

Their son again Joseph married Caroline Gem above and they had five children (four of whom died in 1874). Ann Jenkins Osborn; their remaining child married Frederick Smith in 1890. These were the parents of Mr Alban W Smith of Turners End Farm and Mr Gem Smith of Weston Hall Farm. The Smiths still own Moorhills Farm.

Grove

Eleanor and Emma Grove (13), sisters, were described in census of 1851 as 'Washerwomen' and later in 1961 as 'Laundresses'.

"Ellen" and Emma were daughters of Thomas and Mary Groves who had nine children. Thomas was a carpenter and Mary and her three daughters were all washerwomen (Ellem, Emma and Elizabeth). Another sister Maria, and her husband George Tomms lived with the family.

By 1861 Elizabeth had left the house.

There was also an Uncle, George, who was another carpenter.

—0—

The family home, now gone, occupied a site at the corner of The Avenue and The Old Warwick Rd. This was a smallholding which came into their hands when the grandfather of Ellem and Emma (another Thomas) married a Mary Brown in 1788, she being heir to her fathers' land.

Gumbley

Matthew Gumbley (34) d.1879, shoemaker living in Lowsonford.

Herbert

A Henry Herbert (178) d.1798 in Rowington although he was not born in the parish. His wife Anne is not recorded in Parish Records. There were no longer any Herberts resident in Rowington by 1848.

King

Joseph King (147) was a wealthy landowner in the parish.

Lea

John Lea married Susannah Cookes in 1752 and they went on to have 10 children. (176) Their youngest child Joseph married a Mary Cheshire in 1808.

Joseph and Mary (175) — master carpenter with no children. Lived in what is now the Post House. Mary was renowned for her goodness to the poor.

Hopkins

Joseph Hopkins (60) — Agricultural labourer d.1869.

Mander

The Mander family were resident in Lapworth for some 200 yrs, mostly at Irelands Farm. The Rowington Manders appear to be a branch of the Lapworth family.

Robert Mander (64) and his wife Mary farmed at Finwood Hill Farm in 1848 holding 47 acres.

There were 5 daughters: Rebecca (63), Mary (62), Ann, Elizabeth (63) and Jane. The latter eventually inherited the farm.

Another branch of the Mander family lived at Weston Hall Farm.

Pettit

The Pettits resided in Rowington for many years, at one time at Hickecroft in Mill Lane. Sometimes recorded as Petty in Parish Records.

John Pettit (138) d.1828 was the father of the 19th century family. His wife was Mary d.1818.

John and Mary's children were Elizabeth, Thomas, Martha and Esther, but the John (138) who died in 1825 may have been another son.

Thomas Pettit married Elizabeth Stead in 1820, and produced several children. In 1841 their eldest son Thomas jnr was described as looking after all the children with the help of a servant. He died the following year.(137).

William, another son was a gardener.

John the second son was a cordwainer who lived at Hickecroft (which was at one time divided into two dwellings). He married Maria. John d.1847.

Maria stayed on at Hickecroft of which she was the owner with her son Thomas aged 6 in 1851 and her sister in law Ann as a lodger. Ann was a dressmaker whilst Maria continued her husband's trade,

being described in 1861 as "boot and shoebinder".

Later, through an unpaid mortgage the property passed out of the family's hands after Maria's death.

Plant

Frances Plant (169) Schoolmaster, his wife a governess. In 1861 Parish Clerk and Collector of Taxes, "Assistant Overseer of the Poor".

Reeve

The Reeve family(s) resided in Rowington for at least three centuries. In the earlier days they were mostly Catholics and only their births are recorded in Parish Records.

Benjamin Reeve's family can be traced back to 1617 when his father John was baptised. John was a twin and as there is no further record of his brother Thomas in records it is believed that he died.

Benjamin married Elizabeth in or about 1668 and they had the children listed on the memorial in church. They lived at North Rookery and over the fireplace there are still the letters

NR

B R

E R

to commemorate the birth of Nethaniel.

1669

Elizabeth d.1722. Benjamin d.1726.

Frances (memorial in church) is mentioned in Parish Records as being "wife of Mr. John Reeve", he being "of Tanworth". John d.1773.

Thomas Reeve d.1612 (memorial in church), is recorded as having Isabel as wife and John and Mary as issue.

From Thomas' Will: John inherited the farm upon his fathers' death. £30 was left to Christopher Fleckmore son in law if he made a settlement on his wife Mary.

It is believed that these were the Catholic Reeves' who lived at Gatehouse Farm.

Stead/Barnett/Kendrick

These three families are very interconnected.

Stead or Steed Peter Steed d.1808 had a son John (184) who d.1812.

Kendrick Ann Stead, widow in 1810 married Joseph Kendrick in 1811 and had a son Thomas (179)

Barnett A Mary Stead (185) married James Barnett in 1822 and had seven children.

James Henry (183) was their second son

Another son was James d.1837 (183)

A daughter Mary Anne d.1852 (182).

James Barnett was described as "Innkeeper" and "Victualler" in 1841. His elder son William was a butcher, as was another son, George.

William George Barnett owned the New Inn jointly in 1848 although a tenant actually ran it. By 1861 Wm and his wife were gone.

John Barnett, older brother to James (185) was a miller. John and his wife Sarah had at least 9 children. Thomas, the youngest son was also a miller.

Sly

Ancestors of the Sly (9) family are reputed to have been mentioned in A Midsummer Nights Dream which Shakespeare is said to have written whilst staying at Shakespeare Hall. The Sly family is still represented today in Rowington.

Tibbetts

A branch of a Tibbett family lived in Wroxall.

A William Tibbitts of Wroxall married Mary Wheeler of Rowington in 1815 (158).

Daughters Sarah (157), Elizabeth (158) and Mary (158) also another sister Ann and a son William. The girls and William lived together at Shepherds' Fold (then The Elms) in the 1840's/50's.

Richard Tibbetts (m.Eleanor) was probably the illegitimate son (32) of Hannah Tibbitts.

Wells

The Wells lived at High House (now High Chimneys)

William Wells (56) and his wife Grace were the first of the family in Rowington. They already had a son, Thomas when they came in about 1785/6. Grace died and William married again in 1795 to Elizabeth Weale. They had many children.

Among them William (54) Elizabeth (52), Penelope (55) and George Richard (53).

Thomas Wells, from the first marriage inherited the farm and he and his wife May had several children — among them Katherine (57).

Thomas himself died (58) in 1864, his wife d.1850.

Williams

George Williams, married Sarah Sly in 1796, he being a Brickmaker. They had 7 children and lived in what is now Lynton Cottage.

William their son b.1810 married Hannah (35) and in the census of 1851 he was an “Agricultural Labourer”. They were both 40 yrs old and had a son William jnr aged 2 yrs. By 1861’ William was “a Farmer” with 9 acres of land.

Joseph, another son of George b.1800 married Ann. He was also an Agricultural Labourer. By 1851 they were on Parish Relief. By 1861 he was a widower and working as a Labourer on the roads.

There was another family of Williams’ in Rowington — Samuel and Mary, he being a Labourer with 3 children: Mary, Isaac and Sarah. Mary snr d.1825 and Samuel remarried to a Sarah and they produced William, Charles and Ann.

Samuel d.1835 aged 40 and Sarah now a widow was recorded in 1841 as living with the children plus another woman and her son in a cottage in the churchyard. William was then an Agricultural Labourer, and he later married Adelaide, having 3 children and living in a cottage on Rowington Green.